

Optical Cable Duct



Catalogo Out Line Canaline

Versione Documento 2.0

Tel. +39 0690405273

info@outline.company - www.outline.company

Via degli Olmetti, 39D - 00060 Formello (RM)

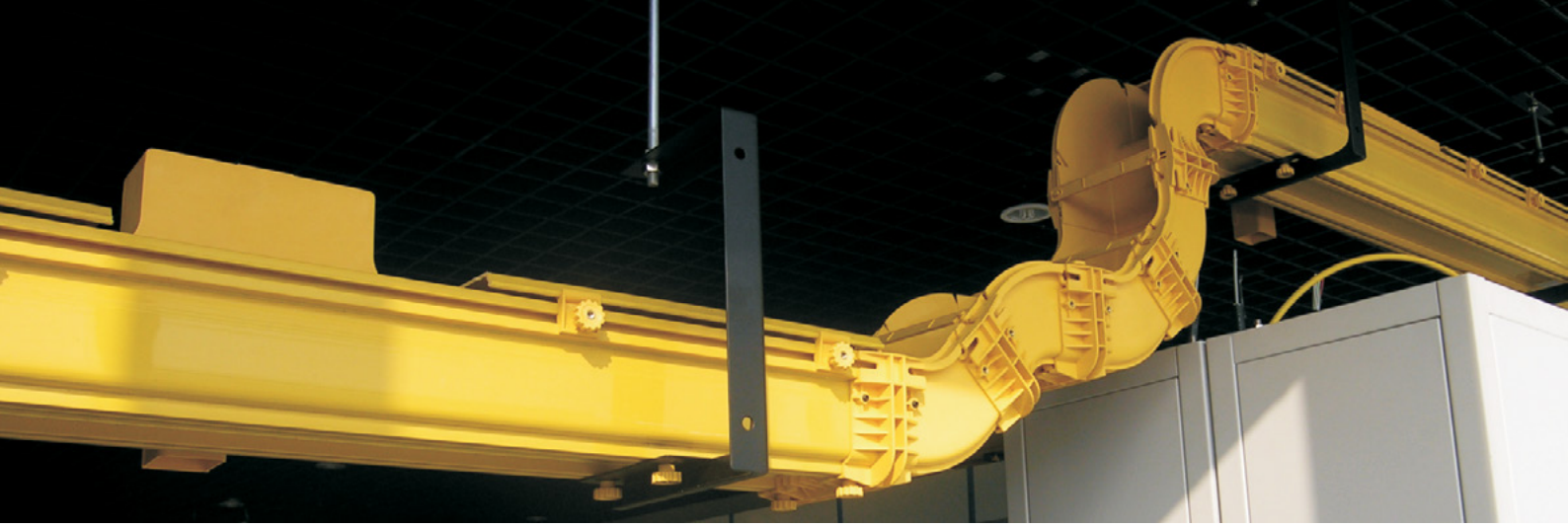

OPTICAL CABLE DUCT INTRODUCTION

Brief Introduction:

- Optical cable duct is a system designed to protect and route fiber optic patch cords, cable assemblies to and from guide closures, ODF and other terminal devices.
- Optical cable duct offers ideal solutions for optical raceway requirements and application with pleasing appearance and easy maintenance.
- Flame-retardant materials with flame rate of V0.
- Tool-less products boast easy and quick installation including snap-on cover, hinged cover option as well as quick exits.
- Sizes from 2" x 2" to 4" x 12"
- Capacity

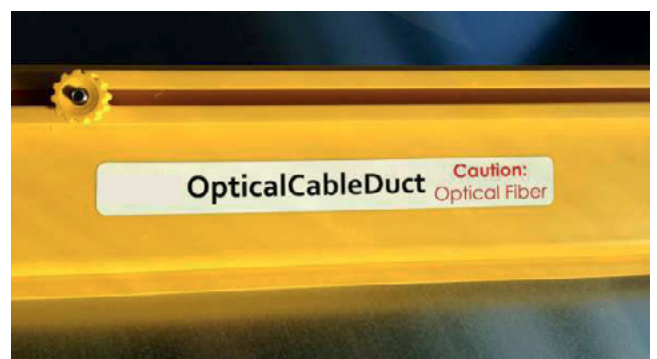

Specifications Cable diameter	2"×2"system		4"×4"system		4"×6"system		4"×10"system		4"×12"system	
Accumulated height	2.0mm	3.0mm	2.0mm	3.0mm	2.0mm	3.0mm	2.0mm	3.0mm	2.0mm	3.0mm
5cm	408	176	816	352	1224	528	2040	880	2448	1056
7.5cm	-	-	1224	528	1836	792	3060	1320	3672	1584
11cm	-	-	1632	704	2448	1056	4080	1760	4896	2112





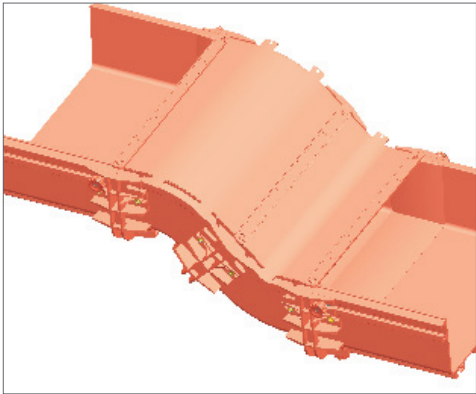

P6~18 - Size

2" (2"×2" 50mm × 50mm).....	6
4 " (4"×4" 100mm × 100mm).....	8
6 " (4"×6" 100mm × 150mm).....	11
10" (4"×10" 100mm × 250mm).....	14
12" (4"×12" 100mm × 300mm).....	16

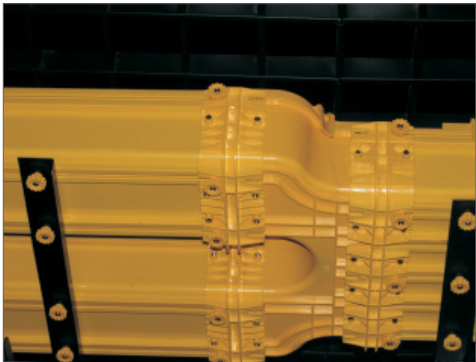

P22~23

Hybrid Coupler / Adapter.....	22
-------------------------------	----



P24~30 - Exit Drop Options

2" Quick Exit with Flex Tube / Trumpet Flare Drop 1.....	24
2" Quick Exit with Flex Tube / Trumpet Flare Drop 2.....	25
2" Fixed Exit with Flex Tube / Trumpet Flare Drop.....	26
4" Quick Exit with Flex Tube / Trumpet Flare Drop 1.....	27
4" Quick Exit with Flex Tube / Trumpet Flare Drop 2.....	28
4" Fixed Exit with Flex Tube / Trumpet Flare Drop.....	29
Downspout with Trumpet Flare / Trumpet Flare Drop.....	30

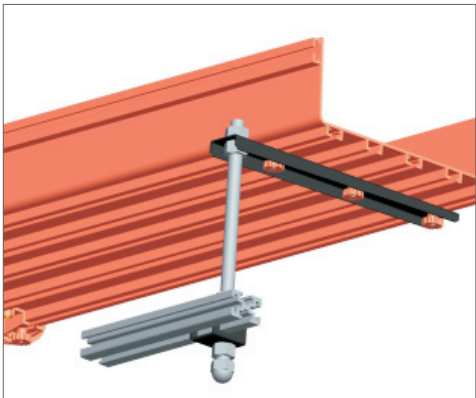

P34~36 - Installation / Supporting Systems

Anchor Support.....	34
Trapeze Support	35
Top of Rack / Cabinet Support	35
Auxiliary Framing support	36
Wall Support	36

OPTICAL CABLE DUCT

2" (2"×2" 50MM × 50MM)



Straight Unit
P/N: A101

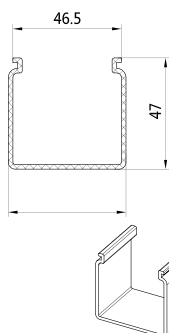
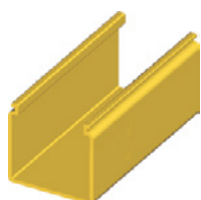

Remarks: 2 meter/piece •

Straight Unit Cover
P/N: A102

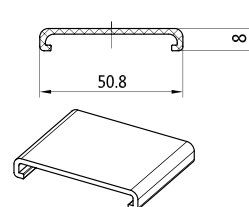
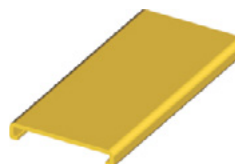

Remarks: 2 meter/piece •

End Cap
P/N: A114

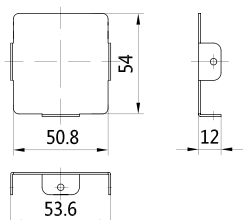

Remarks: Metal,
used for straight unit.

Coupler
P/N: A108

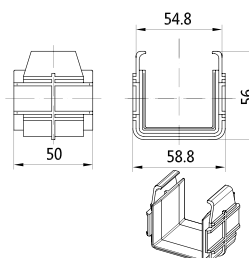

90° Horizontal Curve
P/N: A104

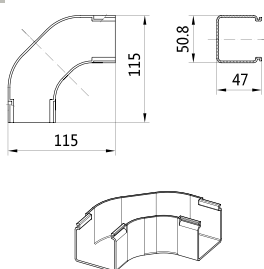

90° Horizontal Curve Cover
P/N: A105

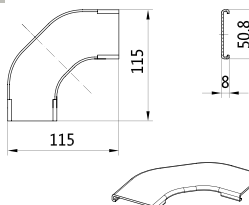

Horizontal T
P/N: A106

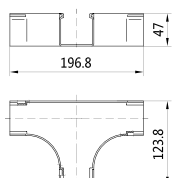

Horizontal T Cover
P/N: A107

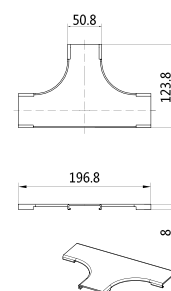

OPTICAL CABLE DUCT

2" (2"×2" 50MM × 50MM)



90° Up Curve
P/N: A115

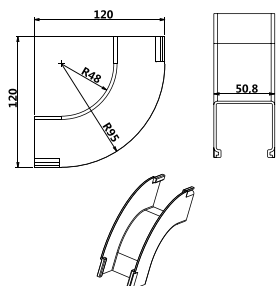

90° Up Curve Cover
P/N: A116

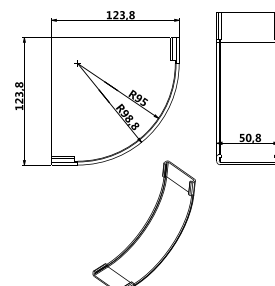

90° Down Curve
P/N: A117

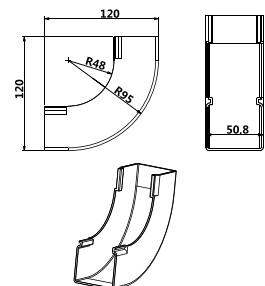

90° Down Curve Cover
P/N: A118

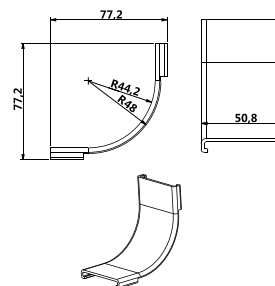

* Other length is available upon request.

OPTICAL CABLE DUCT

4" (4"×4" 100MM × 100MM)



Straight Unit
P/N: A203

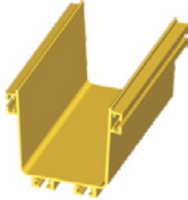

Remarks: 2 meter/piece *

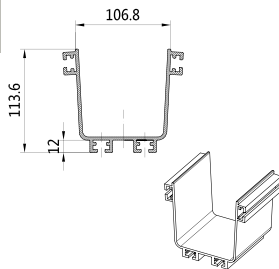

Straight Unit Cover Kit
P/N: T202

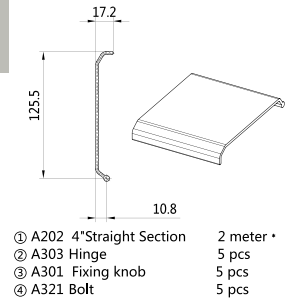
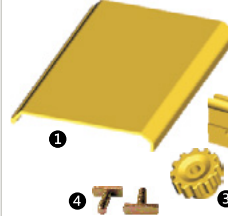

- ① A202 4" Straight Section 2 meter *
- ② A303 Hinge 5 pcs
- ③ A301 Fixing knob 5 pcs
- ④ A321 Bolt 5 pcs

End Cap
P/N: A214



Remarks: Metal,
used for straight unit.

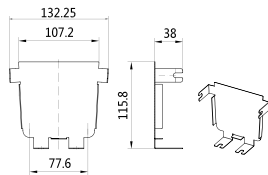

Bolt and Fixing Knob not included

Special Part End Cap
P/N: A216



Remarks: Metal,
used for special part.

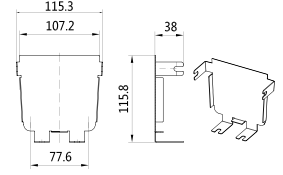

Bolt and Fixing Knob not included

Coupler Kit A
P/N: T2041

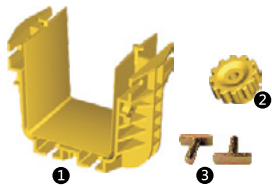

Remarks: Straight Unit Coupler

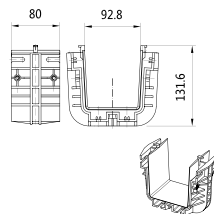

- ① A204 4" Connector 1
- ② A301 Fixing Knob 8
- ③ A321 Bolt 8

Coupler Kit B
P/N: T2042

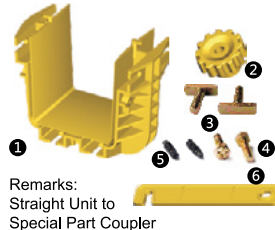

Remarks:
Straight Unit to
Special Part Coupler

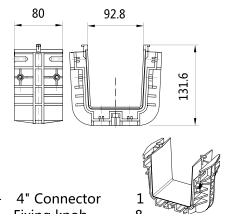

- ① A204 4" Connector 1
- ② A301 Fixing knob 8
- ③ A321 Bolt 4
- ④ GB5780-86 M6*25 Hexagonal Bolt 4
- ⑤ GB79-85M6*14 Inner Hexagon Screw 3
- ⑥ A201 4" Pull Rod 1

Coupler Kit S
P/N: T2042 S



Remarks:
Special Part to
Special Part Coupler

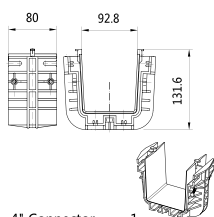

- ① A204 4" Connector 1
- ② A301 Fixing knob 8
- ③ GB5780-86 M6*25 Hexagonal Bolt 8
- ④ GB79-85M6*14 Inner Hexagon Screw 6
- ⑤ A201 4" Pull Rod 1

Vertical Cover Kit 4"
P/N: T203

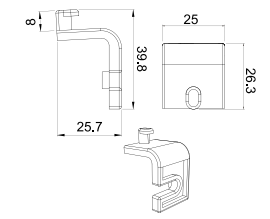
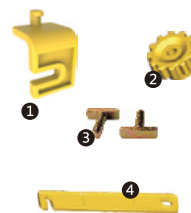

- ① P303 Hinge for pull rod 2
- ② A301 Fixing Knob 2
- ③ A321 Bolt 2
- ④ A201 4" Pull Rod 1

90° Horizontal Curve
P/N: A211

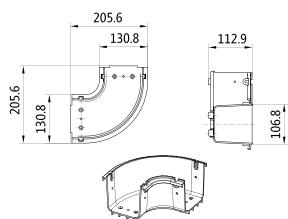
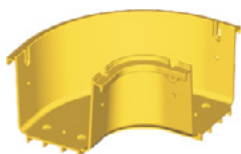

90° Horizontal Curve Cover
P/N: A212

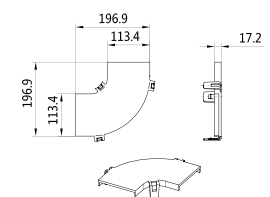

* Other length is available upon request.

OPTICAL CABLE DUCT

4" (4"×4" 100MM × 100MM)



Storage Duct
P/N: T231

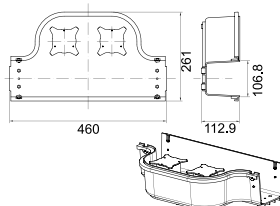
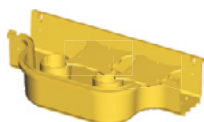

Storage Duct Cover
P/N: A232

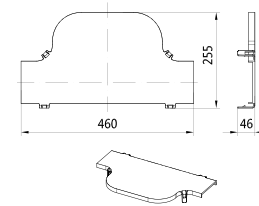

Horizontal T
P/N: A205

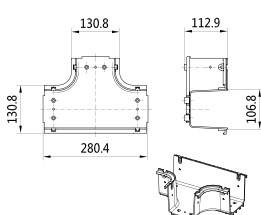
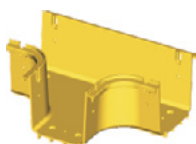

Horizontal T Cover
P/N: A206

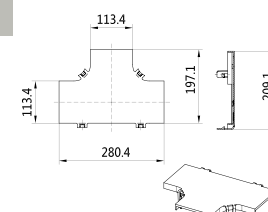

45° Down Curve
P/N: A208

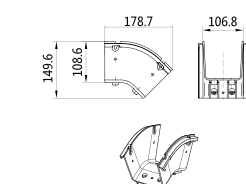

45° Down Curve Cover Kit
P/N: T220

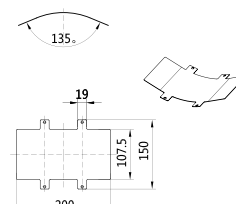

Remarks: Metal material.

- | | |
|--|---|
| ① A220 4" 45° Down Curve Cover | 1 |
| ② A215 Fixing unit | 4 |
| ③ GB818-85 M4*10 Cross Recessed Pan Head Screw | 4 |

45° Up Curve
P/N: A207

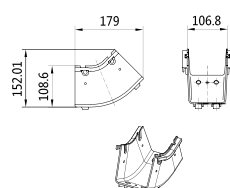

45° Up Curve Cover Kit
P/N: T219

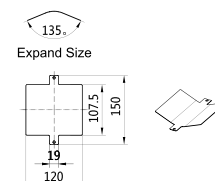
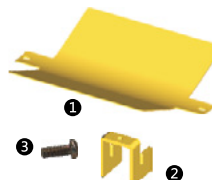

Remarks: Metal material.

- | | |
|--|---|
| ① A219 4" 45° Up Curve Cover | 1 |
| ② A215 Fixing unit | 2 |
| ③ GB818-85 M4*10 Cross Recessed Pan Head Screw | 2 |

90° Down Curve
P/N: A209

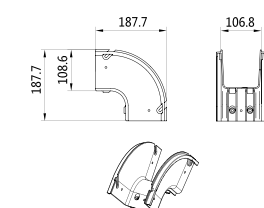

90° Down Curve Cover Kit
P/N: T221

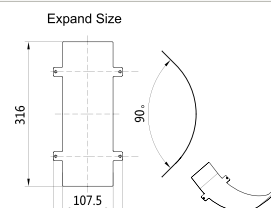
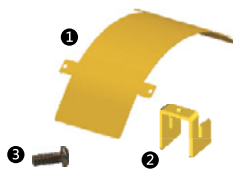

Remarks: Metal material.

- | | |
|--|---|
| ① A221 4" 90° Down Curve Cover | 1 |
| ② A215 Fixing unit | 4 |
| ③ GB818-85 M4*10 Cross Recessed Pan Head Screw | 4 |

OPTICAL CABLE DUCT

4" (4"×4" 100MM × 100MM)



Horizontal Cross
P/N: A235

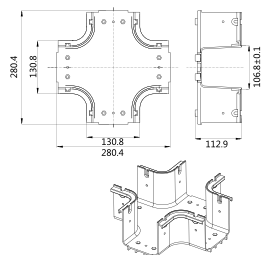
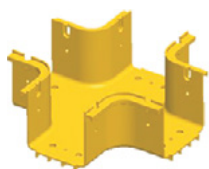

Horizontal Cross Cover
P/N: A236

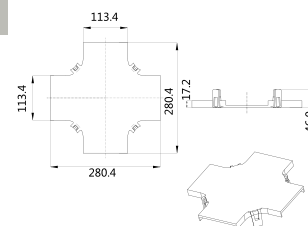

Vertical T
P/N: A241

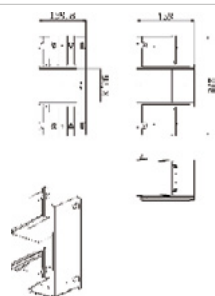

Vertical T Cover
P/N: A242

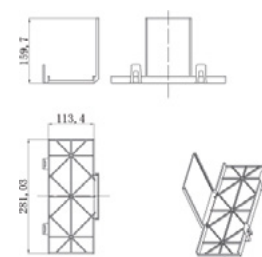

Kit coupler spill over
P/N: T2043

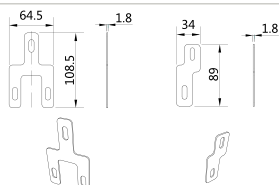
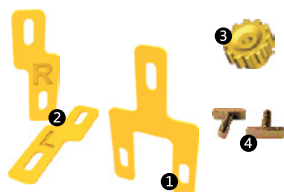

- | | | |
|--------|--------------------------------|---|
| ① A299 | 4" Vertical Y Back Coupler | 1 |
| ② A298 | 4" Vertical Left/Right Coupler | 2 |
| ③ A301 | Fixing Knob | 7 |
| ④ A321 | Bolt | 7 |

Remarks:
Special Part to Special Part Coupler

OPTICAL CABLE DUCT

6" (4"×6" 100MM × 150MM)



Straight Unit
P/N: A319

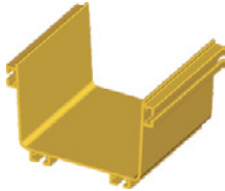

Remarks: 2 meter/piece *

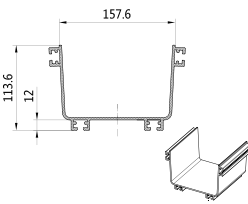

Straight Unit Cover Kit
P/N: T302

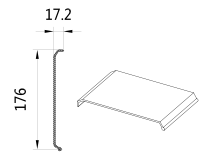
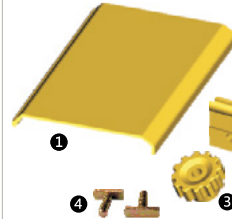

- ① A302 6" Straight Section Cover 2 meter *
- ② A303 Hinge 5 pcs
- ③ A301 Fixing knob 5 pcs
- ④ A321 Bolt 5 pcs

End Cap
P/N: A322

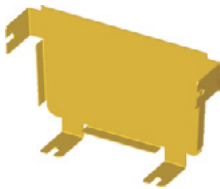

Remarks: Metal,
used for straight unit.

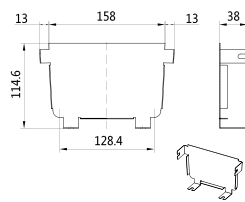

Bolt and Fixing Knob not included

Special Part End Cap
P/N: A325



Remarks: Metal,
used for special part.

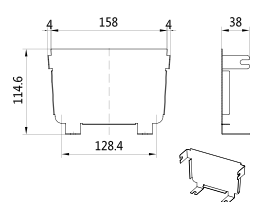

Bolt and Fixing Knob not included

Coupler Kit A
P/N: T3161

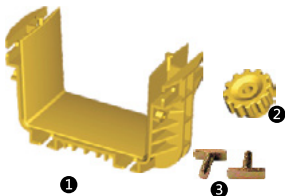

Remarks: Straight Unit Coupler

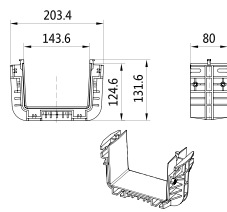

- ① A316 6" Coupler 1
- ② A301 Fixing Knob 8
- ③ A321 Bolt 8

Coupler Kit B
P/N: T3162

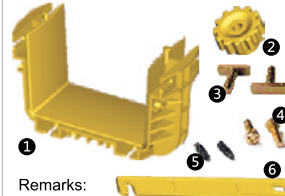

Remarks:
Straight Unit to
Special Part Coupler

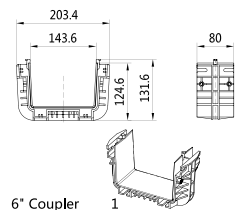

- ① A316 6" Coupler 1
- ② A301 Fixing Knob 8
- ③ A321 Bolt 4
- ④ GB5780-86 M6*25 Hexagonal Bolt 4
- ⑤ GB79-85M6*14 Inner Hexagon Screw 4
- ⑥ A304 6" Pull Rod 1

Coupler Kit S
P/N: T3162 S



Remarks:
Special Part to
Special Part Coupler

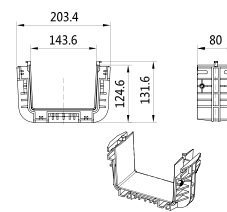

- ① A316 6" Connector 1
- ② A301 Fixing Knob 8
- ③ GB5780-86 M6*25 Hexagonal Bolt 8
- ④ GB79-85M6*14 Inner Hexagon Screw 8
- ⑤ A304 6" Pull Rod 1

Vertical Cover Kit
P/N: T303

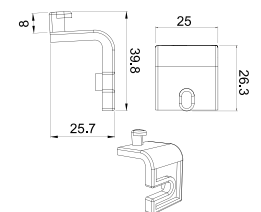
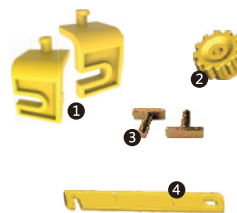

- ① P303 Hinge for pull rod 2
- ② A301 Fixing Knob 2
- ③ A321 Bolt 2
- ④ A304 6" Pull Rod 1

90° Horizontal Curve
P/N: A315

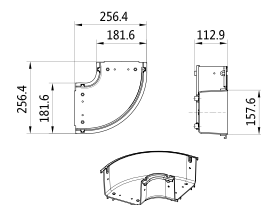
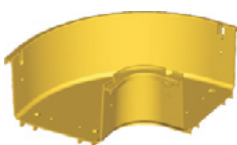

90° Horizontal Curve Cover
P/N: A318

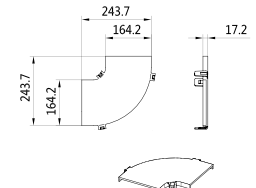

* Other length is available upon request.

OPTICAL CABLE DUCT

6" (4"×6" 100MM × 150MM)



Horizontal T
P/N: A317

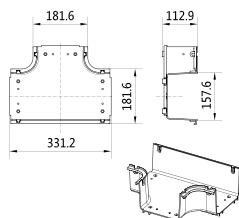
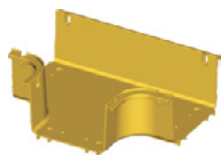

Horizontal T Cover
P/N: A314

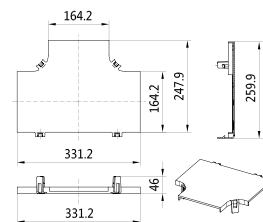

Horizontal Cross
P/N: A327

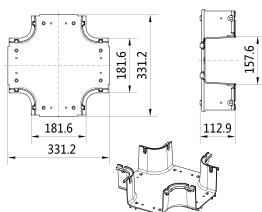
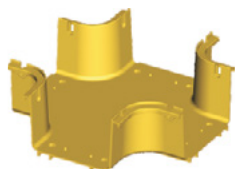

Horizontal Cross Cover
P/N: A328

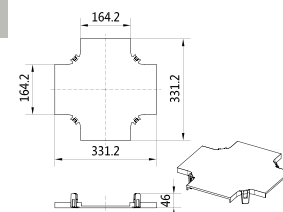

45° Down Curve
P/N: A306

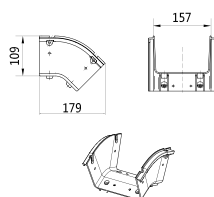

45° Down Curve Cover Kit
P/N: T335

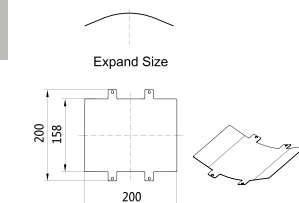
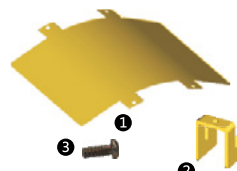

Remarks: Metal material.

① A335 6" 45° Down Curve Cover	1
② A215 Fixing unit	4
③ GB818-85 M4*10 Cross Recessed Pan Head Screw	4

45° Up Curve
P/N: A307

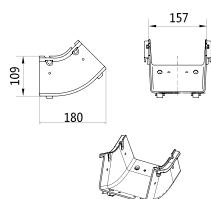

45° Up Curve Cover Kit
P/N: T334

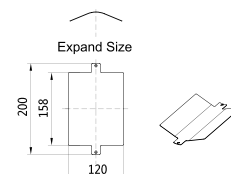
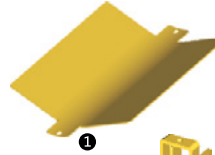

Remarks: Metal material.

① A334 6" 45° Up Curve Cover	1
② A215 Fixing unit	2
③ GB818-85 M4*10 Cross Recessed Pan Head Screw	2

90° Down Curve
P/N: A305

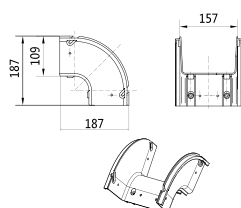

90° Down Curve Cover Kit
P/N: T336

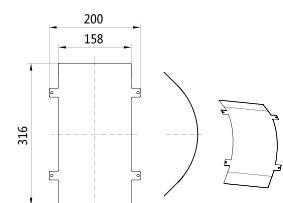
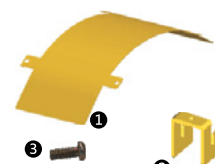

Remarks: Metal material

① A336 6" 90° Down Curve Cover	1
② A215 Fixing unit	4
③ GB818-85 M4*10 Cross Recessed Pan Head Screw	4

OPTICAL CABLE DUCT

6" (4"x6" 100MM x 150MM)



Storage Duct
P/N: T347

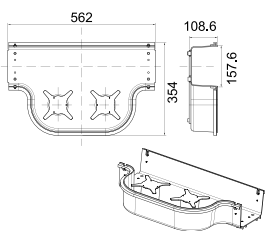
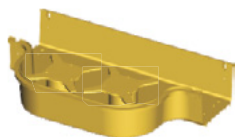

Storage Duct Cover
P/N: A349

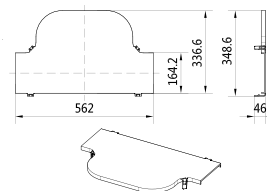

Fitting for Transitions Kit
P/N: AD-OLPAN6X4

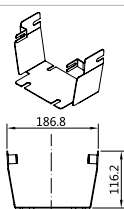
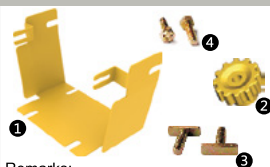

Template for holes



Remarks:
Fitting for transitions from
PANDUIT's 6x4 FiberRunner™ System
to 6x4 Fiber Duct Out Line System

- | | |
|--|---|
| ① OLAPAN12x4 6" Metal coupler from PAN to OL | 1 |
| ② A301 Fixing knob | 8 |
| ③ A321 Bolt | 6 |
| ④ GB5780-86 M6*25 Hexagonal Bolt | 2 |

Fitting for Transitions Kit
P/N: AD-OLADC6x4

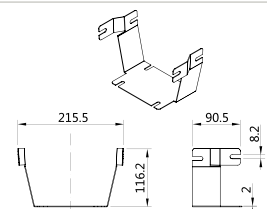

Remarks:
Fitting for transitions from
ADC's 6x4 FiberRunner™ System
to 6x4 Fiber Duct Out Line System

- | | |
|--|---|
| ① OLADC6x4 6" Metal coupler from ADC to OL | 1 |
| ② A301 Fixing knob | 8 |
| ③ A321 Bolt | 8 |
| ④ GB-16-8 OUT16xIN8,5 washer | 4 |

OPTICAL CABLE DUCT

10" (4"×10" 100MM × 250MM)



Straight Unit
P/N: A501

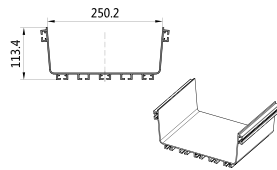
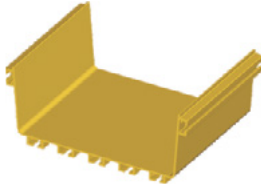

Remarks: 2 meter/piece •

Straight Unit Cover
P/N: A510

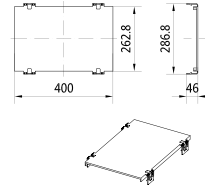

Remarks: 40 cm/pc, Snap-on Cover.

Coupler Kit A
P/N: T5021

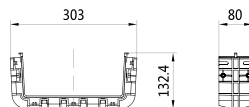
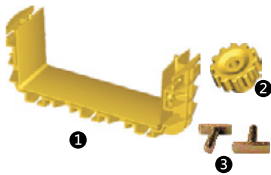

- ① A502 10" Connector 1
- ② A301 Fixing knob 10
- ③ A321 Bolt 10

Remarks: Straight Unit Coupler

Coupler Kit B
P/N: T5022

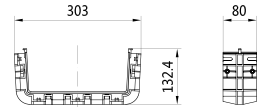
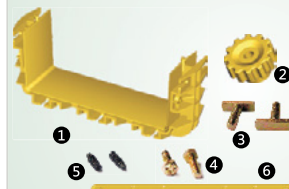

- ① A502 10" Coupler 1
- ② A301 Fixing knob 10
- ③ A321 Bolt 5
- ④ GB5780-86 M6*25 Hexagonal Bolt 5
- ⑤ GB79-85M6*14 Inner Hexagon Screw 6
- ⑥ A514 10" Pull Rod 1

Remarks:
Straight Unit to Special Part Coupler

Coupler Kit S
P/N: T5022 S

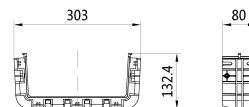
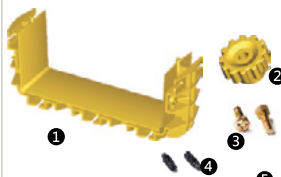

- ① A502 10" Coupler 1
- ② A301 Fixing knob 10
- ③ GB5780-86 M6*25 Hexagonal Bolt 10
- ④ GB79-85M6*14 Inner Hexagon Screw 12
- ⑤ A514 10" Pull Rod 1

Remarks:
Special Part to Special Part Coupler

90° Horizontal Curve
P/N: A513

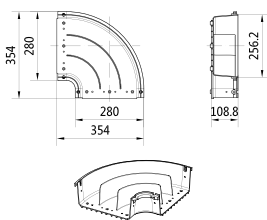
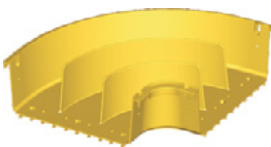

90° Horizontal Curve Cover
P/N: A512

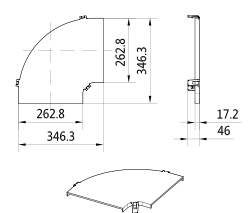

Horizontal T
P/N: A504

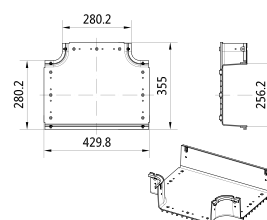
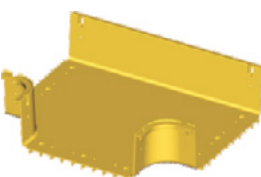

Horizontal T Cover
P/N: A507

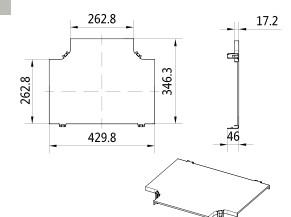

* Other length is available upon request.

OPTICAL CABLE DUCT

10" (4"×10" 100MM × 250MM)



Horizontal Cross
P/N: A503

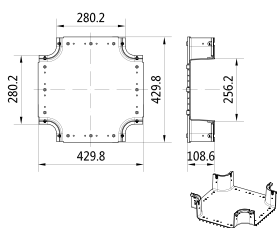

Horizontal Cross Cover
P/N: A506

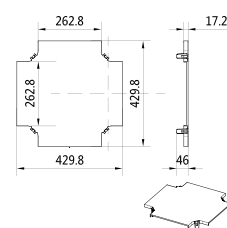

End Cap
P/N: A522

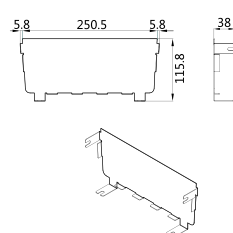

Remarks: Metal,
used for straight unit.

Bolt and Fixing Knob not included

Special Part End Cap
P/N: A529

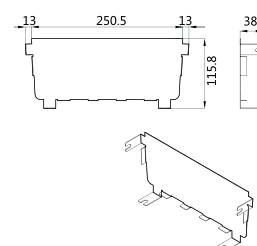

Remarks: Metal,
used for special part.

Bolt and Fixing Knob not included

OPTICAL CABLE DUCT

12" (4"×12" 100MM × 300MM)



Straight Unit
P/N: A403

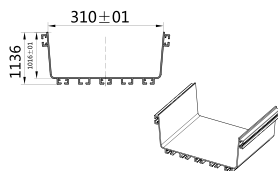
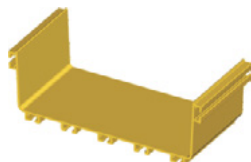

Remarks: 2 meter/piece *

Straight Unit Cover
P/N: A422

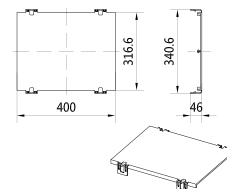

Remarks: 40 cm/pc, Snap-on Cover

Coupler Kit A
P/N: T4281

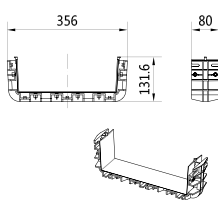
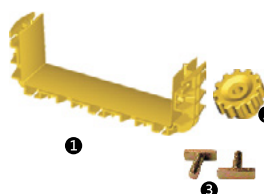

- | | |
|--------------------|----|
| ① A428 12" Coupler | 1 |
| ② A301 Fixing knob | 10 |
| ③ A321 Bolt | 10 |

Remarks: Straight Unit Coupler

Coupler Kit B
P/N: T4282

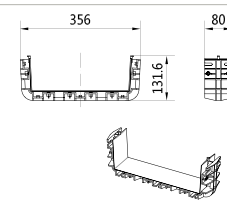
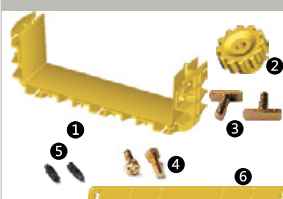

- | | |
|------------------------------------|----|
| ① A428 12" Coupler | 1 |
| ② A301 Fixing knob | 10 |
| ③ A321 Bolt | 5 |
| ④ GB5780-86 M6*25 Hexagonal Bolt | 5 |
| ⑤ GB79-85M6*14 Inner Hexagon Screw | 6 |
| ⑥ A401 12" Pull Rod | 1 |

Remarks:
Straight Unit to Special Part Coupler

Coupler Kit S
P/N: T4282 S

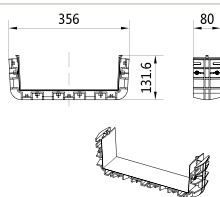

- | | |
|------------------------------------|----|
| ① A428 12" Connector | 1 |
| ② A301 Fixing knob | 10 |
| ③ GB5780-86 M6*25 Hexagonal Bolt | 10 |
| ④ GB79-85M6*14 Inner Hexagon Screw | 12 |
| ⑤ A401 12" Pull Rod | 1 |

Remarks:
Special Part to Special Part Coupler

End Cap
P/N: A431

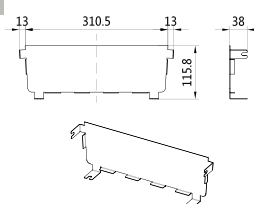

Remarks: Metal,
used for straight unit.

Bolt and Fixing Knob not included

Special Part End Cap
P/N: A434

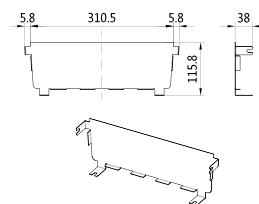

Remarks: Metal,
used for special part.

Bolt and Fixing Knob not included

90° Horizontal Curve
P/N: A429

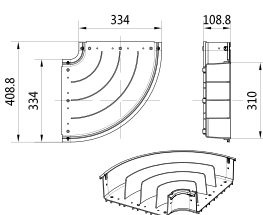

90° Horizontal Curve Cover
P/N: A425

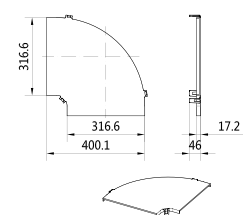

* Other length is available upon request.

OPTICAL CABLE DUCT

12" (4"×12" 100MM × 300MM)



Horizontal T
P/N: A417

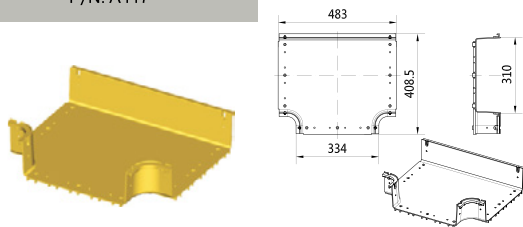

Horizontal T Cover
P/N: A418

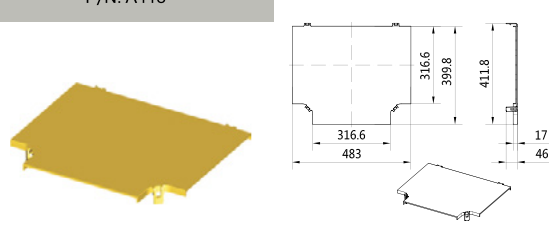

Horizontal Cross
P/N: A407

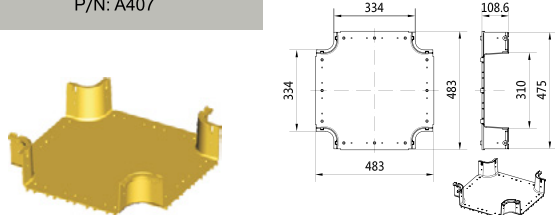

Horizontal Cross Cover
P/N: A420

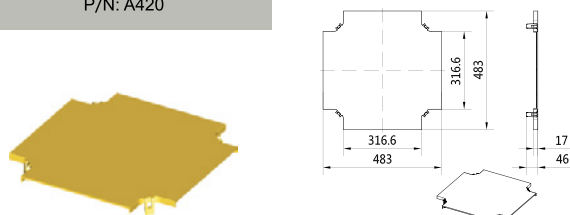

45° Horizontal Curve
P/N: A427

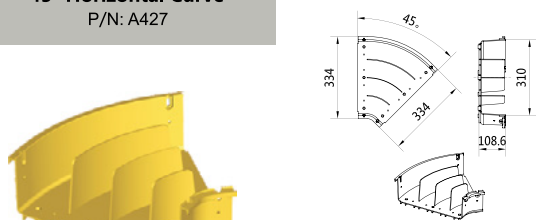

45° Horizontal Curve Cover
P/N: A426

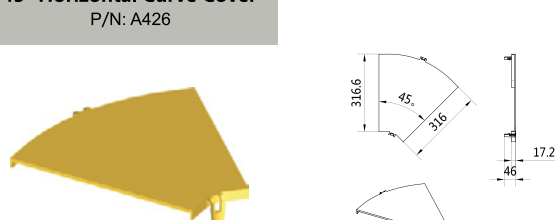

45° Down Curve
P/N: A405

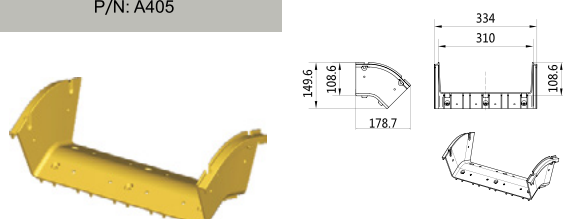

45° Down Curve Cover Kit
P/N: T438

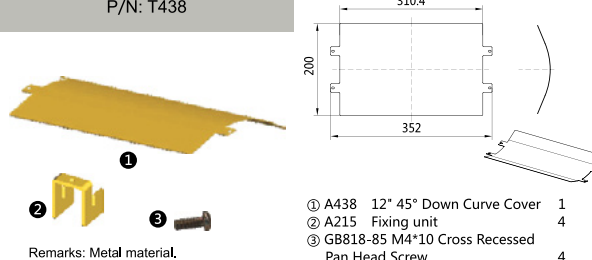

45° Up Curve
P/N: A406

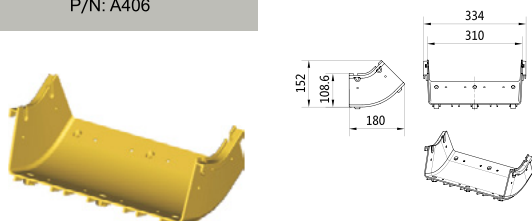

45° Up Curve Cover Kit
P/N: T437

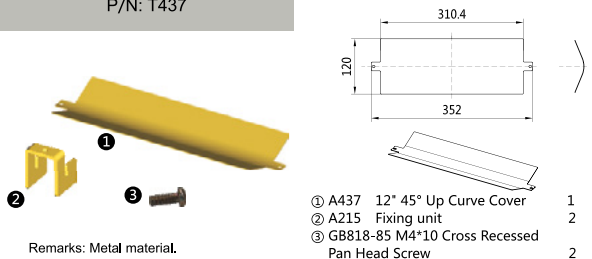

OPTICAL CABLE DUCT

12" (4"×12" 100MM × 300MM)



90° Down Curve P/N : A404

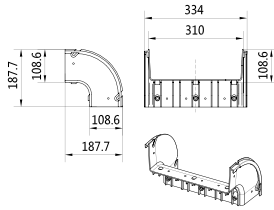

90° Down Curve Cover Kit P/N: T439

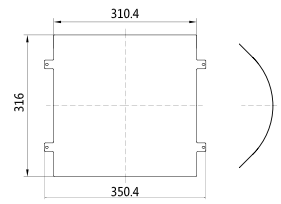
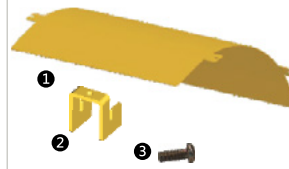

- ① A439 12" 90° Down Curve Cover 1
- ② A215 Fixing unit 4
- ③ GB818-85 M4*10 Cross Recessed Pan Head Screw 4

Remarks: Metal material.

Fitting for Transitions Kit P/N: AD-OLPAN12x4

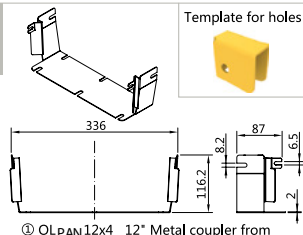

Template for holes



Remarks:
Fitting for transitions from
PAN's 12x4 FiberRunner™ System
to 12x4 Fiber Duct Out Line System

- ① OLPAN12x4 12" Metal coupler from PAN to OL 1
- ② A301 Fixing knob 10
- ③ A321 Bolt 8
- ④ GB5780-86 M6*25 Hexagonal Bolt 2

Fitting for Transitions Kit P/N: AD-OLADC12x4

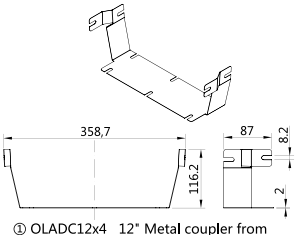

Remarks:
Fitting for transitions from
ADC's 12x4 FiberRunner™ System
to 12x4 Fiber Duct Out Line System

- ① OLADC12x4 12" Metal coupler from ADC to OL 1
- ② A301 Fixing knob 10
- ③ A321 Bolt 10
- ④ GB-16-8 OUT16xIN8,5 washer 5



Out Line
SOLUZIONI INNOVATIVE

Remarks:

[illegible]

Straight Unit Cover Installation -- 4" & 6"

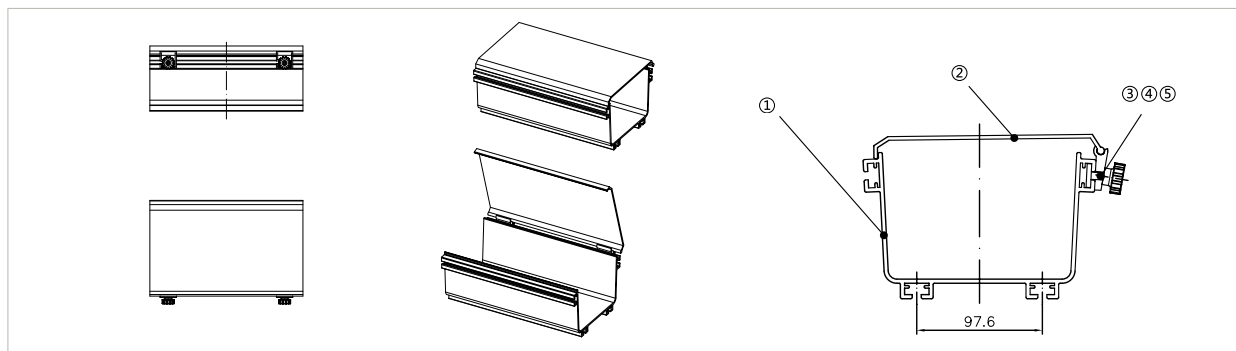

Straight Unit Cover Kit

	Item	P/N	Part	Quantity		Item	P/N	Part	Quantity
4" P/N: T202	①	A203	4" Straight Unit		6" P/N: T302	①	A319	6" Straight Unit	
	②	A202	4" Straight Unit Cover Kit	2 meter		②	A302	6" Straight Unit Cover Kit	2 meter
	③	A303		5 pcs		③	A303		5 pcs
	④	A321		5 pcs		④	A321		5 pcs
	⑤	A301		5 pcs		⑤	A301		5 pcs

Coupler Installation

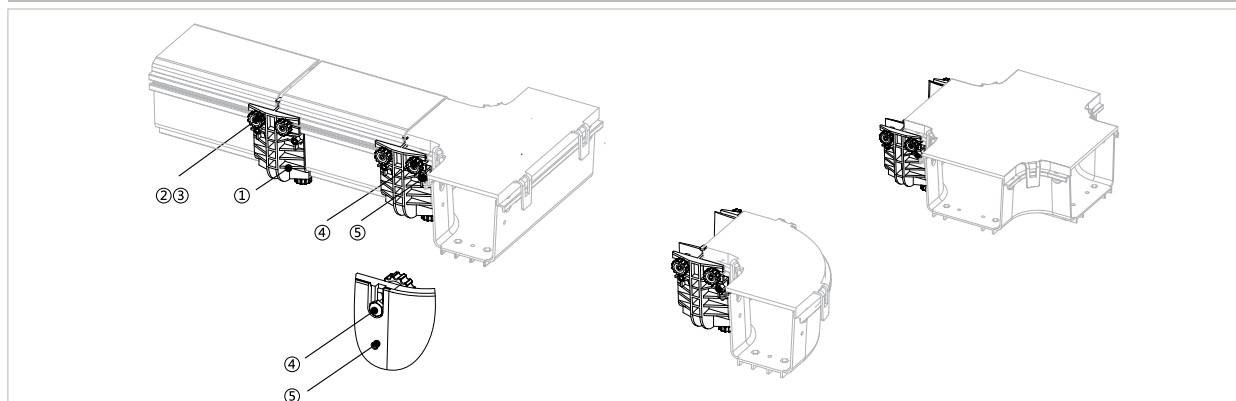

Coupler Kit A For Straight Sections

	Item	P/N	Part	Quantity		Item	P/N	Part	Quantity
4" P/N: T2041	①	A204	4" Coupler Kit A	1	6" P/N: T3161	①	A316	6" Coupler Kit A	1
	②	A301		8		②	A301		8
	③	A321		8		③	A321		8
10" P/N: T5021	①	A502	10" Coupler Kit A	1	12" P/N: T4281	①	A428	12" Coupler Kit A	1
	②	A301		10		②	A301		10
	③	A321		10		③	A321		10

Coupler Kit B For Other Parts

	Item	P/N	Part	Quantity		Item	P/N	Part	Quantity
4" P/N: T2042	①	A204	4" Coupler Kit B	1	6" P/N: T3162	①	A316	6" Coupler Kit B	1
	②	A301		8		②	A301		8
	③	A321		4		③	A321		4
	④	GB5780-86		4		④	GB5780-86		4
	⑤	GB79-85		3		⑤	GB79-85		4
10" P/N: T5022	①	A502	10" Coupler Kit B	1	12" P/N: T4282	①	A428	12" Coupler Kit B	1
	②	A301		10		②	A301		10
	③	A321		5		③	A321		5
	④	GB5780-86		5		④	GB5780-86		5
	⑤	GB79-85		6		⑤	GB79-85		6

Example

45° Climbing Installation (4")

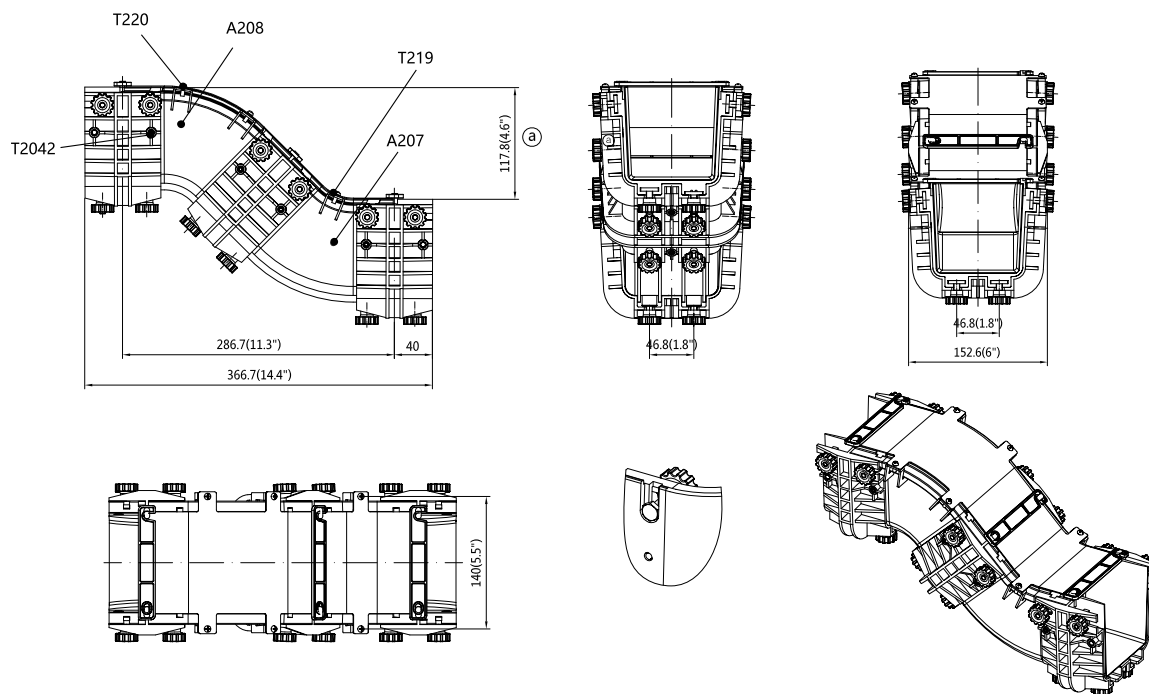

90° Climbing Installation (4")

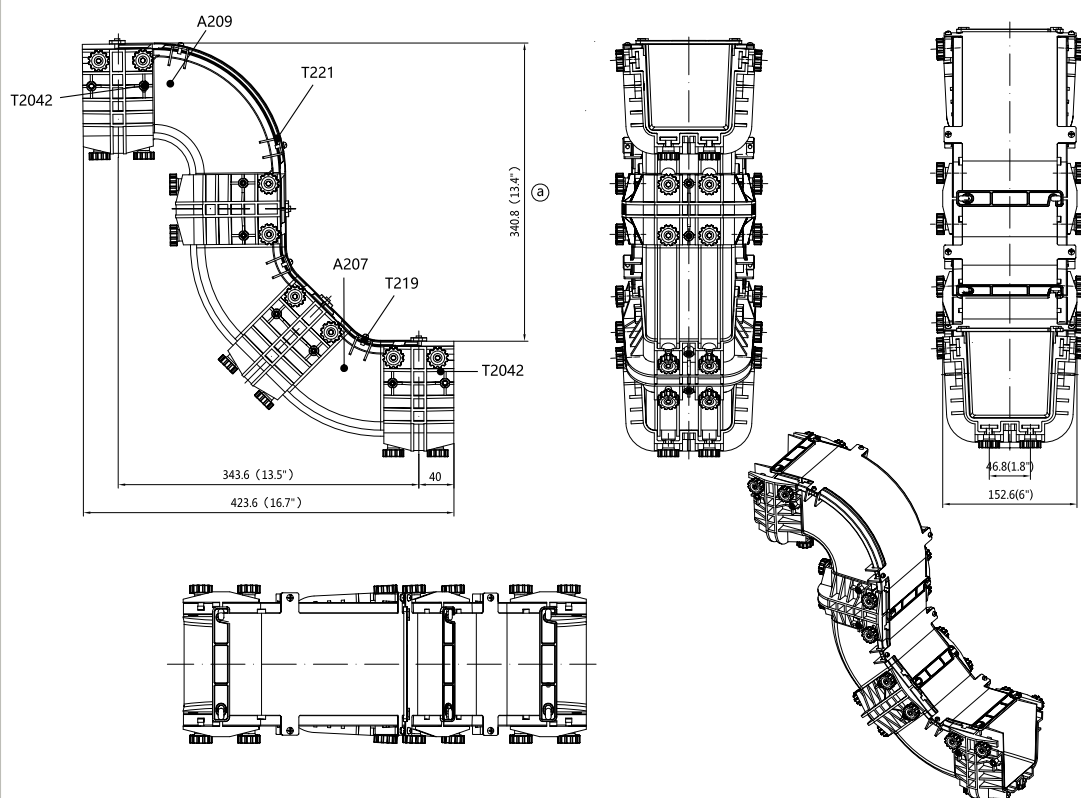

OPTICAL CABLE DUCT

HYBRID COUPLER / ADAPTERS



6" to 4" Horizontal T
P/N: A320

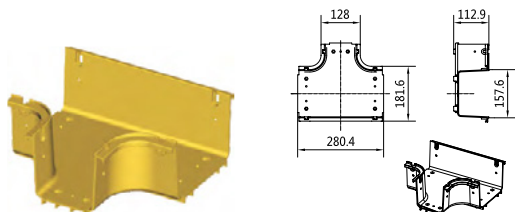

6" to 4" Horizontal T Cover
P/N: A313

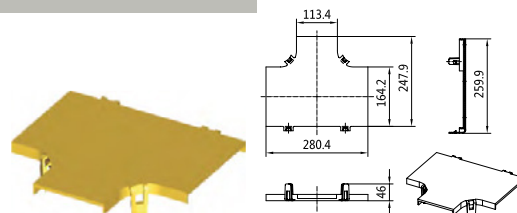

6" to 4" Horizontal Cross
P/N: A326

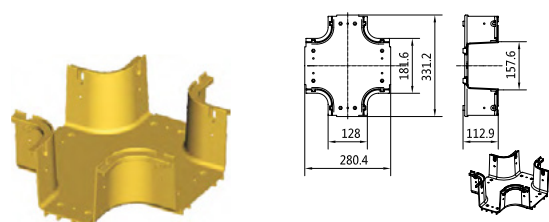

6" to 4" Horizontal Cross Cover
P/N: A329

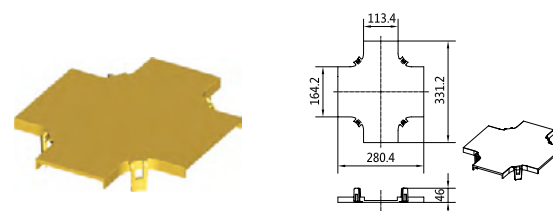

6" to 4" Adapter
P/N: A350

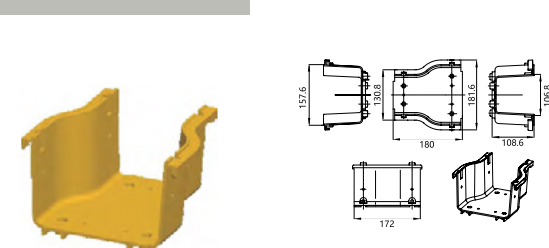

6" to 4" Adapter Cover
P/N: A351

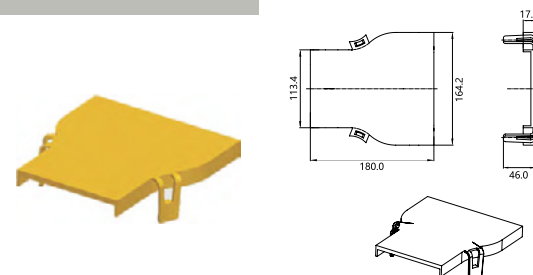

10" to 6" Adapter
P/N: A505

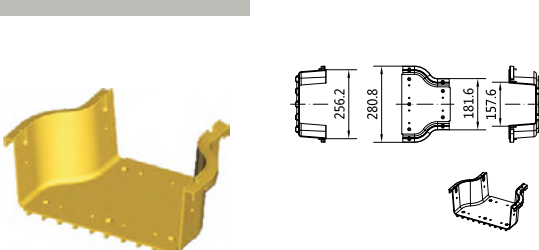

10" to 6" Adapter Cover
P/N: A509

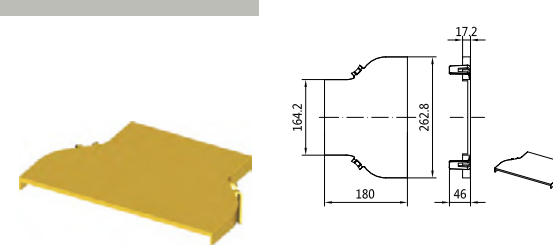

OPTICAL CABLE DUCT

HYBRID COUPLER / ADAPTERS



12" to 6" Adapter
P/N: A409

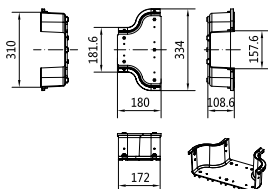

12" to 6" Adapter Cover
P/N: A424

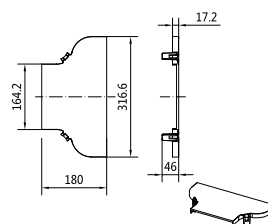

12" to Dual 6" Adapter
P/N: A411

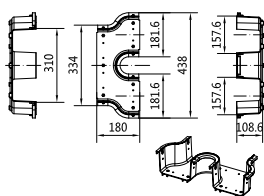

12" to Dual 6" Adapter Cover
P/N: A423

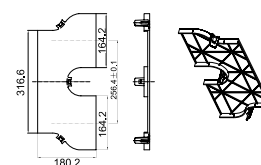

12" to 6" Horizontal T
P/N: A408

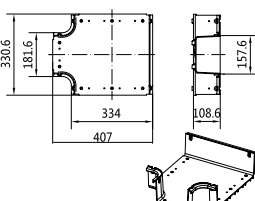

12" to 6" Horizontal T Cover
P/N: A419

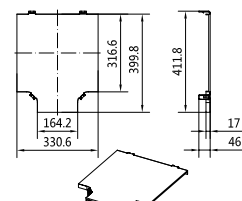
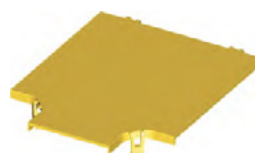

12" to 6" Horizontal Cross
P/N: A410

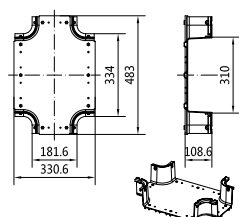
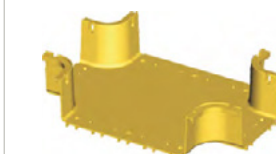

12" to 6" Horizontal Cross Cover
P/N: A421

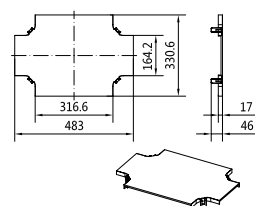

12" to 10" Coupler Kit
P/N: T445

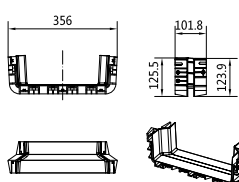

- | | |
|-----------------------------|---|
| ① A445 12" to 10" Connector | 1 |
| ② A301 Fixing knob | 8 |
| ③ A321 Bolt | 8 |

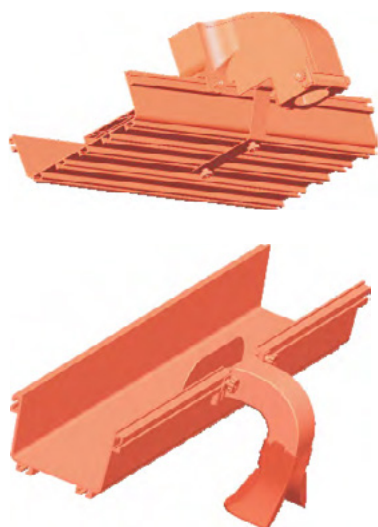

Flex Tube (diameter: 80mm)
P/N: C80



Flex Tube (diameter: 35mm)
P/N: C35



Flex tube retention clip (For C35)
P/N: A35

2" Quick Exit with Flex Tube Drop 1

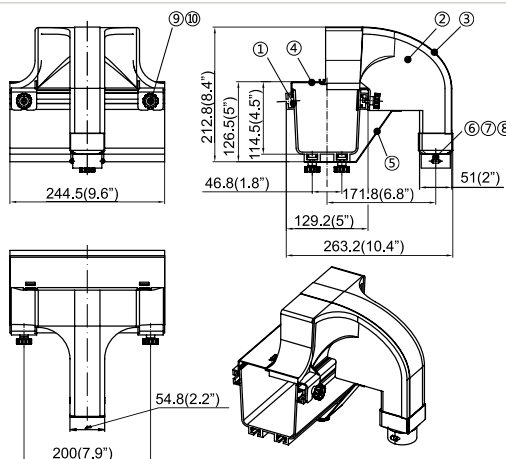

Exit Kit for 4" Duct P/N: T3091

Item	P/N	Part	Quantity
①	A203	4" Straight Unit	N/A
②	A309	2" Quick Exit	1
③	A311	2" Quick Exit Cover	1
④	A250	2" Quick Exit End Cover	1
⑤	A213	4" Supporting Bracket	1
⑥	A109	Splat	1
⑦	A110	Fiber Exit Coupler	1
⑧	GB818-85	M3*8Cross Recessed Pan Head Screw	2
⑨	A301	Fixing Knob	4
⑩	A321	Bolt	4

Exit Kit for 6" Duct P/N: T3092

Item	P/N	Part	Quantity
①	A319	6" Straight Unit	N/A
②	A309	2" Quick Exit	1
③	A311	2" Quick Exit Cover	1
④	A312	2" Quick Exit End Cover	1
⑤	A223	6" Supporting Bracket	1
⑥	A109	Splat	1
⑦	A110	Fiber Exit Connector	1
⑧	GB818-85	M3*8Cross Recessed Pan Head Screw	2
⑨	A301	Fixing Knob	4
⑩	A321	Bolt	4

2" Quick Exit with Trumpet Flare Drop 1

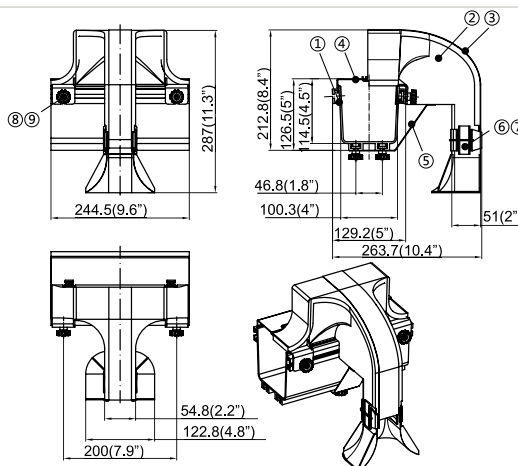

Exit Kit for 4" Duct P/N: T3093

Item	P/N	Part	Quantity
①	A203	4" Straight Unit	N/A
②	A309	2" Quick Exit	1
③	A311	2" Quick Exit Cover	1
④	A250	2" Quick Exit End Cover	1
⑤	A213	4" Supporting Bracket	1
⑥	A108	2" Coupler	1
⑦	A103	Trumpet Flare	1
⑧	A301	Fixing Knob	4
⑨	A321	Bolt	4

Exit Kit for 6" Duct P/N: T3094

Item	P/N	Part	Quantity
①	A319	6" Straight Unit	N/A
②	A309	2" Quick Exit	1
③	A311	2" Quick Exit Cover	1
④	A312	2" Quick Exit End Cover	1
⑤	A223	6" Supporting Bracket	1
⑥	A108	2" Coupler	1
⑦	A103	Trumpet Flare	1
⑧	A301	Fixing Knob	4
⑨	A321	Bolt	4

OPTICAL CABLE DUCT

EXIT DROP OPTIONS



2" Quick Exit with Flex Tube Drop 2

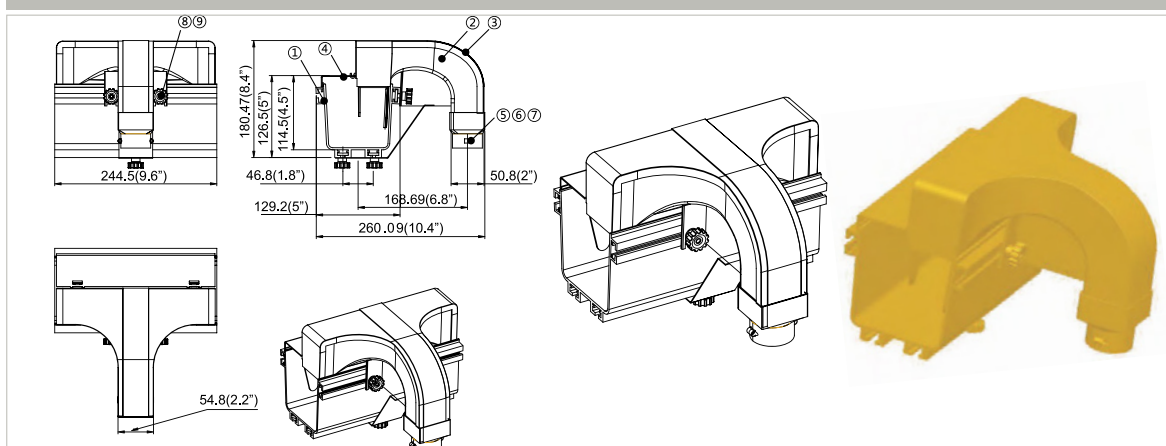

Exit Kit for 4" Duct P/N: T2341

	Item	P/N	Part	Quantity
P/N: T2341	①	A203	4" Straight Unit	N/A
	②	A234	2" Quick Exit	1
	③	A233	2" Quick Exit Cover	1
	④	A250	2" Quick Exit End Cover	1
	⑤	A109	Splat	1
	⑥	A110	Fiber Exit Coupler	1
	⑦	GB818-85	M3*8Cross Recessed Pan Head Screw	2
	⑧	A301	Fixing Knob	2
	⑨	A321	Bolt	2

Exit Kit for 6" Duct P/N: T2342

	Item	P/N	Part	Quantity
P/N: T2342	①	A319	6" Straight Unit	N/A
	②	A234	2" Quick Exit	1
	③	A233	2" Quick Exit Cover	1
	④	A356	2" Quick Exit End Cover	1
	⑤	A109	Splat	1
	⑥	A110	Fiber Exit Coupler	1
	⑦	GB818-85	M3*8Cross Recessed Pan Head Screw	2
	⑧	A301	Fixing Knob	2
	⑨	A321	Bolt	2

2" Quick Exit with Trumpet Flare Drop 2

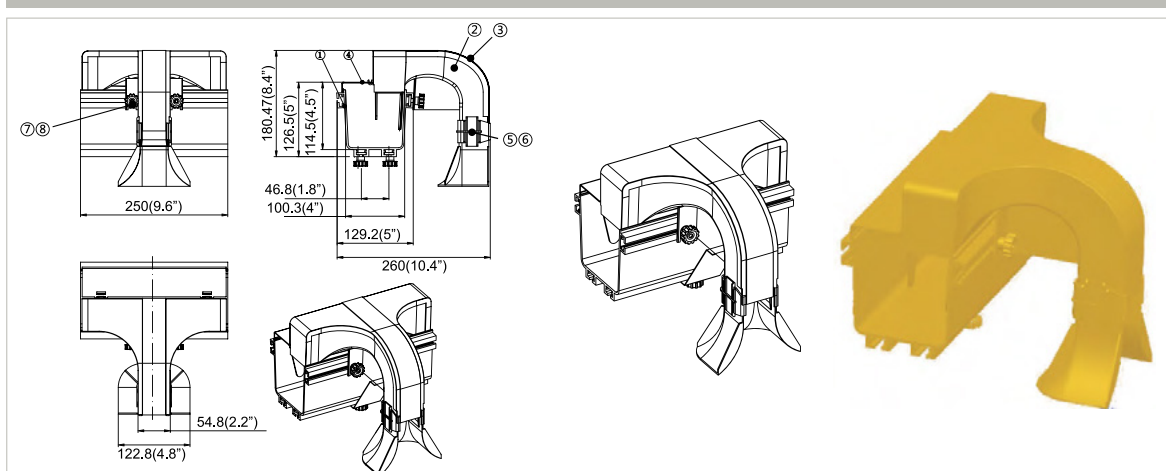

Exit Kit for 4" Duct P/N: T2343

	Item	P/N	Part	Quantity
P/N: T2343	①	A203	4" Straight Unit	N/A
	②	A234	2" Quick Exit	1
	③	A233	2" Quick Exit Cover	1
	④	A250	2" Quick Exit End Cover	1
	⑤	A108	2" Coupler	1
	⑥	A103	Trumpet Flare	1
	⑦	A301	Fixing Knob	2
	⑧	A321	Bolt	2

Exit Kit for 6" Duct P/N: T2344

	Item	P/N	Part	Quantity
P/N: T2344	①	A319	6" Straight Unit	N/A
	②	A234	2" Quick Exit	1
	③	A233	2" Quick Exit Cover	1
	④	A356	2" Quick Exit End Cover	1
	⑤	A108	2" Coupler	1
	⑥	A103	Trumpet Flare	1
	⑦	A301	Fixing Knob	2
	⑧	A321	Bolt	2

OPTICAL CABLE DUCT

EXIT DROP OPTIONS



2" Fixed Exit with Flex Tube Drop (required to remove sidewall)

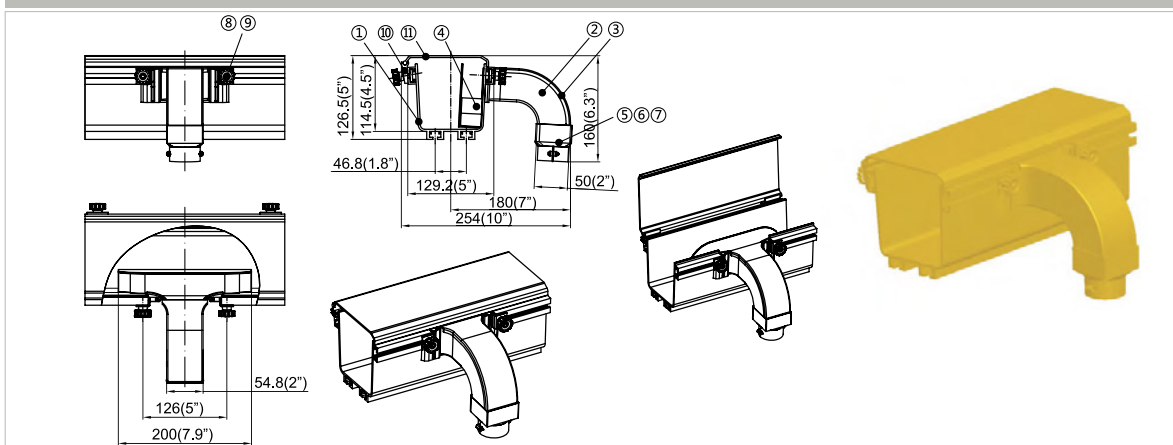

Exit Kit for 4" Duct P/N: T1111

Item	P/N	Part	Quantity
①	A203	4" Straight Unit	N/A
②	A111	2" Fixed Exit	1
③	A113	2" Fixed Exit Cover	1
④	A112	2" Tray Fiber Runner	1
⑤	A109	Splat	1
⑥	A110	Flex tube attachment	1
⑦	A301	Fixing Knob	2
⑧	A321	Bolt	2
⑨	A303	Hinge	
⑩	A202	4" Straight Unit Cover	

Exit Kit for 6" Duct P/N: T1112

Item	P/N	Part	Quantity
①	A319	6" Straight Unit	N/A
②	A111	2" Fixed Exit	1
③	A113	2" Fixed Exit Cover	1
④	A112	2" Tray Fiber Runner	1
⑤	A109	Splat	1
⑥	A110	Flex tube attachment	1
⑦	A301	Fixing Knob	2
⑧	A321	Bolt	2
⑨	A303	Hinge	
⑩	A302	6" Straight Unit Cover	

2" Fixed Exit With Trumpet Flare Drop (required to remove sidewall)

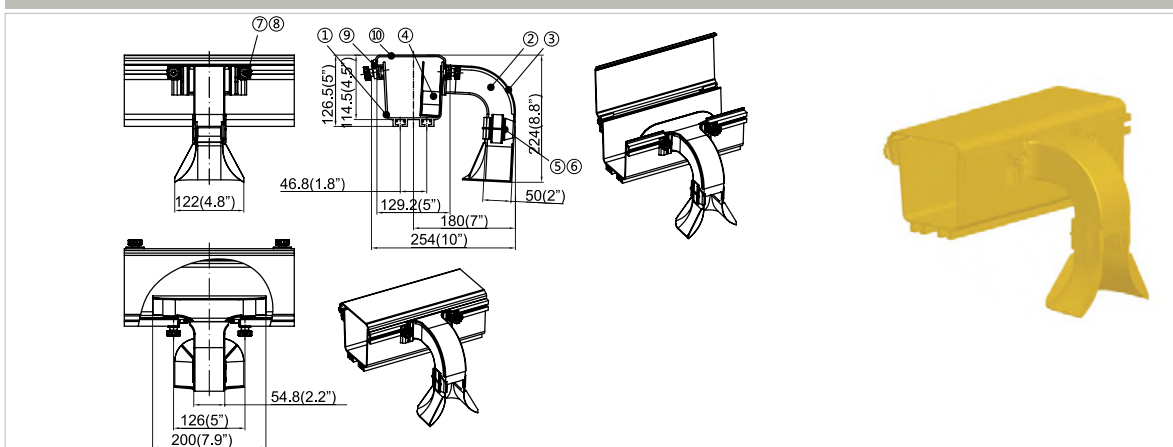

Exit Kit for 4" Duct P/N: T1113

Item	P/N	Part	Quantity
①	A203	4" Straight Unit	N/A
②	A111	2" Fixed Exit	1
③	A113	2" Fixed Exit Cover	1
④	A112	2" Tray Fiber Runner	1
⑤	A108	2" Connector	1
⑥	A103	Trumpet Flare	1
⑦	A301	Fixing Knob	2
⑧	A321	Bolt	2
⑨	A303	Hinge	N/A
⑩	A202	4" Straight Unit Cover	N/A

Exit Kit for 6" Duct P/N: T1114

Item	P/N	Part	Quantity
①	A319	6" Straight Unit	N/A
②	A111	2" Fixed Exit	1
③	A113	2" Fixed Exit Cover	1
④	A112	2" Tray Fiber Runner	1
⑤	A108	2" Connector	1
⑥	A103	Trumpet Flare	1
⑦	A301	Fixing Knob	2
⑧	A321	Bolt	2
⑨	A303	Hinge	N/A
⑩	A302	6" Straight Unit Cover	N/A

OPTICAL CABLE DUCT

EXIT DROP OPTIONS



4" Quick Exit with Flex Tube Drop 1

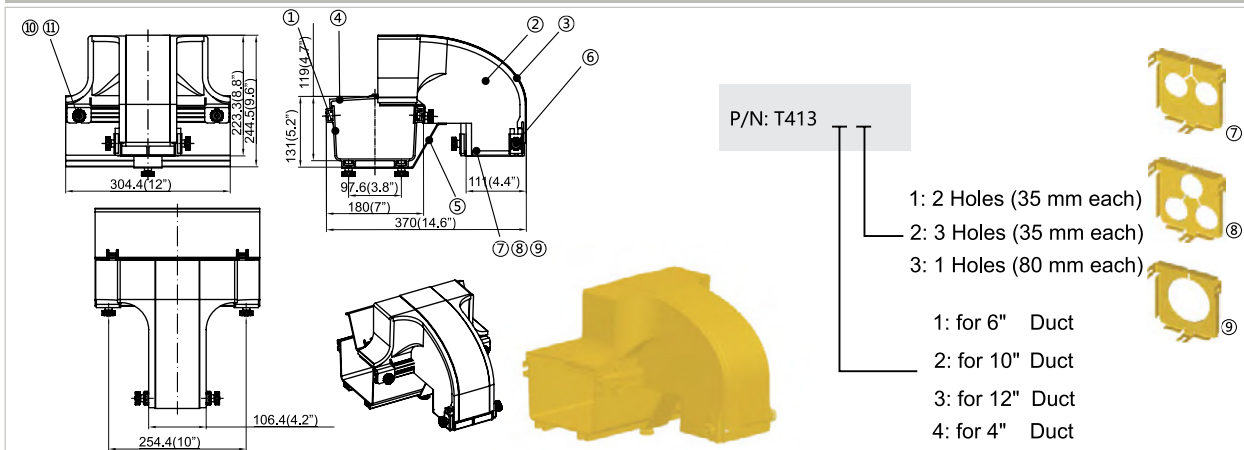

Exit Kit for 4" Duct P/N: T413 _ _					Exit Kit for 6" Duct P/N: T413 _ _				
	Item	P/N	Part	Quantity		Item	P/N	Part	Quantity
P/N: T413 _ _	①	A203	4" Straight Unit	N/A	P/N: T413 _ _	①	A319	6" Straight Unit	N/A
	②	A413	4" Quick Exit	1		②	A413	4" Quick Exit	1
	③	A415	4" Quick Exit Cover	1		③	A415	4" Quick Exit Cover	1
	④	A344	4" Quick Exit End Cover	1		④	A344	4" Quick Exit End Cover	1
	⑤	A213	4" Supporting Bracket	1		⑤	A323	6" Supporting Bracket	1
	⑥	A324	Lock Washer	3		⑥	A324	Lock Washer	3
	⑦	A432	4" Fiber Board (1)	1		⑦	A432	4" Fiber Board (1)	Choose one
	⑧	A433	4" Fiber Board (2)	1		⑧	A433	4" Fiber Board (2)	
	⑨	A443	4" Fiber Board (3)	1		⑨	A443	4" Fiber Board (3)	
	⑩	A301	Fixing Knob	7		⑩	A301	Fixing Knob	7
	⑪	A321	Bolt	7		⑪	A321	Bolt	7

Exit Kit for 10" Duct P/N: T413 __					Exit Kit for 12" Duct P/N: T413 __				
P/N: T413 __	Item	P/N	Part	Quantity	P/N: T413 __	Item	P/N	Part	Quantity
	①	A501	10" Straight Unit	N/A		①	A403	12" Straight Unit	N/A
	②	A413	4" Quick Exit	1		②	A413	4" Quick Exit	1
	③	A415	4" Quick Exit Cover	1		③	A415	4" Quick Exit Cover	1
	④	A511	4" Quick Exit End Cover	1		④	A416	4" Quick Exit End Cover	1
	⑤	A515	10" Supporting Bracket	1		⑤	A430	12" Supporting Bracket	1
	⑥	A324	Lock Washer	3		⑥	A324	Lock Washer	3
	⑦	A432	4" Fiber Board (1)	Choose one		⑦	A432	4" Fiber Board (1)	Choose one
	⑧	A433	4" Fiber Board (2)			⑧	A433	4" Fiber Board (2)	
	⑨	A443	4" Fiber Board (3)			⑨	A443	4" Fiber Board (3)	
	⑩	A301	Fixing Knob	7		⑩	A301	Fixing Knob	7
⑪	A321	Bolt	7	⑪	A321	Bolt	7		

OPTICAL CABLE DUCT

EXIT DROP OPTIONS



4" Quick Exit with Flex Tube Drop 1

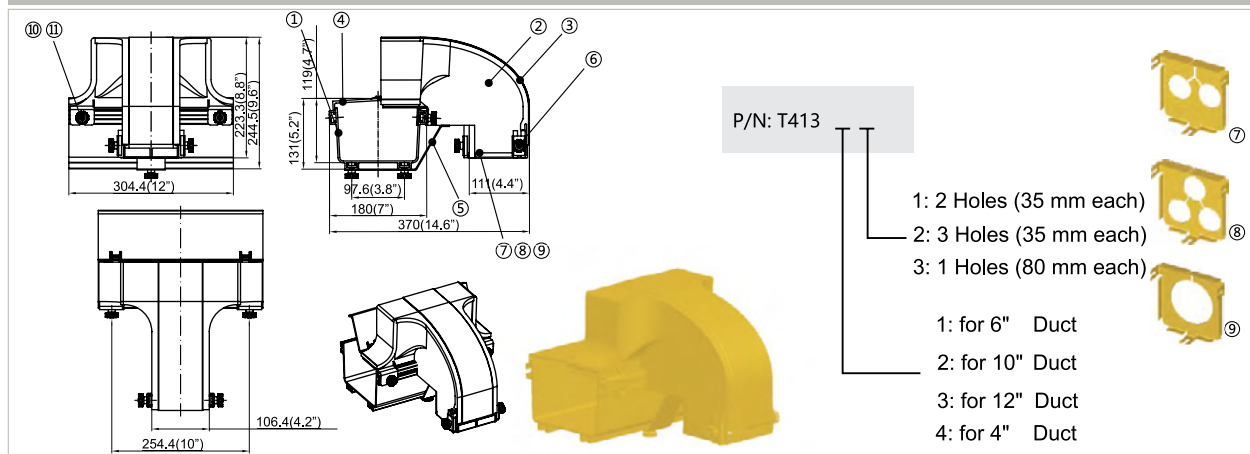

Exit Kit for 4" Duct P/N: T413 __

	Item	P/N	Part	Quantity
P/N: T413 __	①	A203	4" Straight Unit	N/A
	②	A413	4" Quick Exit	1
	③	A415	4" Quick Exit Cover	1
	④	A344	4" Quick Exit End Cover	1
	⑤	A213	4" Supporting Bracket	1
	⑥	A324	Lock Washer	3
	⑦	A432	4" Fiber Board (1)	1
	⑧	A433	4" Fiber Board (2)	1
	⑨	A443	4" Fiber Board (3)	1
	⑩	A301	Fixing Knob	7
	⑪	A321	Bolt	7

Exit Kit for 6" Duct P/N: T413 __

	Item	P/N	Part	Quantity
P/N: T413 __	①	A319	6" Straight Unit	N/A
	②	A413	4" Quick Exit	1
	③	A415	4" Quick Exit Cover	1
	④	A344	4" Quick Exit End Cover	1
	⑤	A323	6" Supporting Bracket	1
	⑥	A324	Lock Washer	3
	⑦	A432	4" Fiber Board (1)	Choose one
	⑧	A433	4" Fiber Board (2)	
	⑨	A443	4" Fiber Board (3)	
	⑩	A301	Fixing Knob	7
	⑪	A321	Bolt	7

Exit Kit for 10" Duct P/N: T413 __

	Item	P/N	Part	Quantity
P/N: T413 __	①	A501	10" Straight Unit	N/A
	②	A413	4" Quick Exit	1
	③	A415	4" Quick Exit Cover	1
	④	A511	4" Quick Exit End Cover	1
	⑤	A515	10" Supporting Bracket	1
	⑥	A324	Lock Washer	3
	⑦	A432	4" Fiber Board (1)	Choose one
	⑧	A433	4" Fiber Board (2)	
	⑨	A443	4" Fiber Board (3)	
	⑩	A301	Fixing Knob	7
	⑪	A321	Bolt	7

Exit Kit for 12" Duct P/N: T413 __

	Item	P/N	Part	Quantity
P/N: T413 __	①	A403	12" Straight Unit	N/A
	②	A413	4" Quick Exit	1
	③	A415	4" Quick Exit Cover	1
	④	A416	4" Quick Exit End Cover	1
	⑤	A430	12" Supporting Bracket	1
	⑥	A324	Lock Washer	3
	⑦	A432	4" Fiber Board (1)	Choose one
	⑧	A433	4" Fiber Board (2)	
	⑨	A443	4" Fiber Board (3)	
	⑩	A301	Fixing Knob	7
	⑪	A321	Bolt	7

4" Quick Exit with Trumpet Flare Drop 2

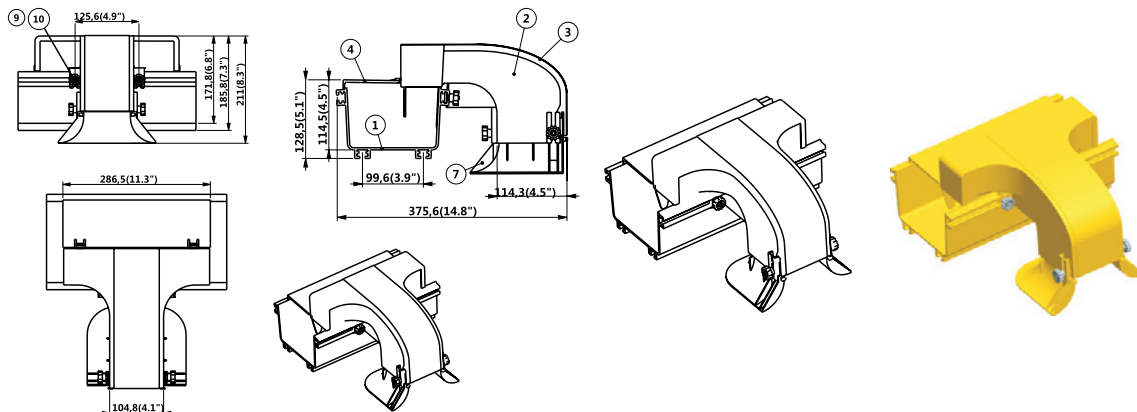

Exit Kit for 4" Duct P/N: T35244					Exit Kit for 6" Duct P/N: T35214				
	Item	P/N	Part	Quantity		Item	P/N	Part	Quantity
P/N: T35244	①	A203	4" Straight Unit	N/A	P/N: T35214	①	A319	6" Straight Unit	N/A
	②	A352	4" Quick Exit	1		②	A352	4" Quick Exit	1
	③	A353	4" Quick Exit Cover	1		③	A353	4" Quick Exit Cover	1
	④	A237	4" Quick Exit End Cover	1		④	A354	6" to 4" Exit End Cover	1
	⑤	A324	Lock Washer	3		⑤	A324	Lock Washer	3
	⑥	A210	4" Trumpet Flare	1		⑥	A210	4" Trumpet Flare	1
	⑦	A201	4" Pull Rod	1		⑦	A201	4" Pull Rod	1
	⑧	A301	Fixing Knob	5		⑧	A301	Fixing Knob	5
	⑨	A321	Bolt	5		⑨	A321	Bolt	5

Exit Kit for 10" Duct P/N: T35224					Exit Kit for 12" Duct P/N: T35234				
	Item	P/N	Part	Quantity		Item	P/N	Part	Quantity
P/N: T35224	①	A501	10" Straight Unit	N/A	P/N: T35234	①	A403	12" Straight Unit	N/A
	②	A352	4" Quick Exit	1		②	A352	4" Quick Exit	1
	③	A353	4" Quick Exit Cover	1		③	A353	4" Quick Exit Cover	1
	⑥	A324	Lock Washer	3		⑥	A324	Lock Washer	3
	⑦	A210	4" Trumpet Flare	1		⑦	A210	4" Trumpet Flare	1
	⑧	A201	4" Pull Rod	1		⑧	A201	4" Pull Rod	1
	⑨	A301	Fixing Knob	5		⑨	A301	Fixing Knob	5
	⑩	A321	Bolt	5		⑩	A321	Bolt	5



4" Quick Exit with Flex Tube Drop 2

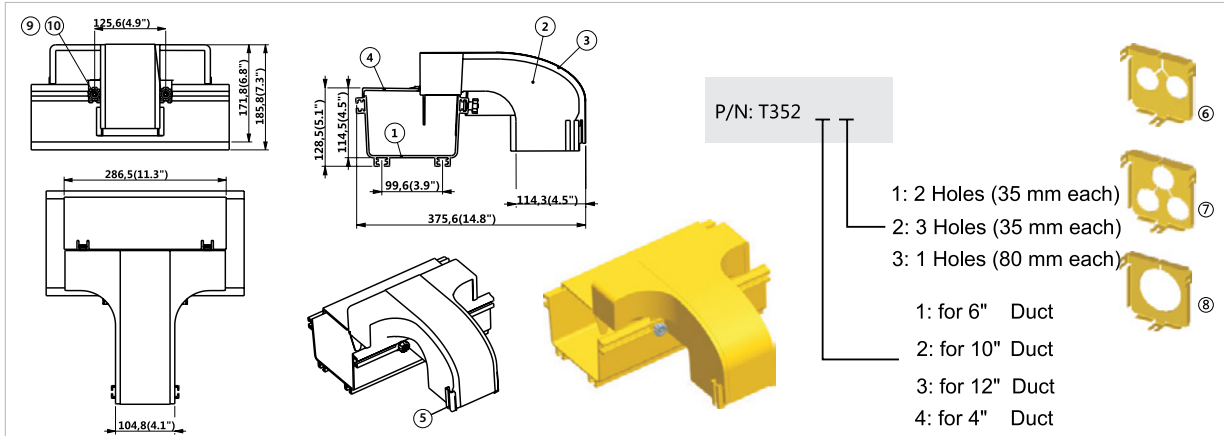

Exit Kit for 4" Duct P/N: T352 __

Item	P/N	Part	Quantity
①	A203	4" Straight Unit	N/A
②	A352	4" Quick Exit	1
③	A353	4" Quick Exit Cover	1
④	A237	4" Quick Exit End Cover	1
⑤	A324	Lock Washer	3
⑥	A432	4" Fiber Board (1)	1
⑦	A433	4" Fiber Board (2)	1
⑧	A443	4" Fiber Board (3)	1
⑨	A301	Fixing Knob	5
⑩	A321	Bolt	5

Exit Kit for 6" Duct P/N: T352 __

Item	P/N	Part	Quantity
①	A319	6" Straight Unit	N/A
②	A352	4" Quick Exit	1
③	A353	4" Quick Exit Cover	1
④	A354	6" to 4" Exit End Cover	1
⑤	A324	Lock Washer	3
⑥	A432	4" Fiber Board (1)	Chose one
⑦	A433	4" Fiber Board (2)	
⑧	A443	4" Fiber Board (3)	
⑨	A301	Fixing Knob	5
⑩	A321	Bolt	5

Exit Kit for 10" Duct P/N: T352 __

Item	P/N	Part	Quantity
①	A501	10" Straight Unit	N/A
②	A352	4" Quick Exit	1
③	A353	4" Quick Exit Cover	1
	A324	Lock Washer	3
	A432	4" Fiber Board (1)	Chose one
	A433	4" Fiber Board (2)	
	A443	4" Fiber Board (3)	
	A301	Fixing Knob	5
	A321	Bolt	5

Exit Kit for 12" Duct P/N: T352 __

Item	P/N	Part	Quantity
①	A403	12" Straight Unit	N/A
②	A352	4" Quick Exit	1
③	A353	4" Quick Exit Cover	1
⑤	A324	Lock Washer	3
⑥	A432	4" Fiber Board (1)	Chose one
⑦	A433	4" Fiber Board (2)	
⑧	A443	4" Fiber Board (3)	
⑨	A301	Fixing Knob	5
⑩	A321	Bolt	5

OPTICAL CABLE DUCT

EXIT DROP OPTIONS



4" Fixed Exit with Flex Tube Drop (required to remove sidewall)

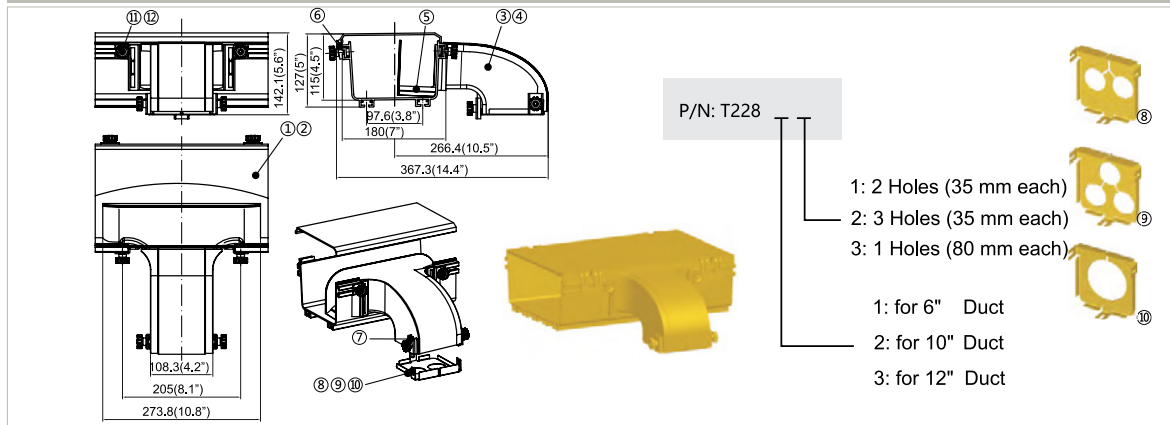

Exit Kit for 6" Duct P/N: T228_				Exit Kit for 10" Duct P/N: T228_				Exit Kit for 12" Duct P/N: T228_			
Item	P/N	Part	Quantity	Item	P/N	Part	Quantity	Item	P/N	Part	Quantity
①	A319	6" Straight Unit	N/A	①	A501	10" Straight Unit	N/A	①	A403	12" Straight Unit	N/A
②	A302	6" Straight Unit Cover	N/A	②	A510	10" Straight Unit Cover	N/A	②	A422	12" Straight Unit Cover	N/A
③	A228	4" Fixed Exit	1	③	A228	4" Fixed Exit	1	③	A228	4" Fixed Exit	1
④	A229	4" Fixed Exit Cover	1	④	A229	4" Fixed Exit Cover	1	④	A229	4" Fixed Exit Cover	1
⑤	A230	4" Runner	1	⑤	A230	4" Runner	1	⑤	A230	4" Runner	1
⑥	A303	Hinge	2	⑦	A324	lock washer	3	⑦	A324	lock washer	3
⑦	A324	lock washer	3	⑧	A432	4" Fiber Board (1)	Choose one	⑧	A432	4" Fiber Board (1)	Choose one
⑧	A432	4" Fiber Board (1)	Choose one	⑨	A433	4" Fiber Board (2)		⑨	A433	4" Fiber Board (2)	
⑨	A433	4" Fiber Board (2)		⑩	A443	4" Fiber Board (3)		⑩	A443	4" Fiber Board (3)	
⑩	A443	4" Fiber Board (3)		⑪	A301	Fixing Knob	5	⑪	A301	Fixing Knob	5
⑪	A301	Fixing Knob	7	⑫	A321	Bolt	5	⑫	A321	Bolt	5
⑫	A321	Bolt	7								

4" Fixed Express Exit With Trumpet Flare

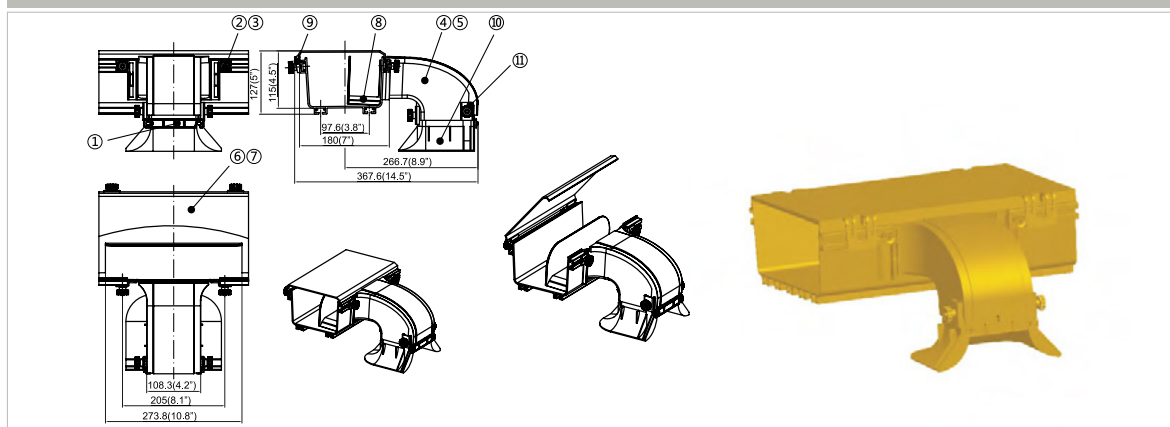

Exit Kit for 6" Duct P/N: T22814				Exit Kit for 10" Duct P/N: T22824				Exit Kit for 12" Duct P/N: T22834			
Item	P/N	Part	Quantity	Item	P/N	Part	Quantity	Item	P/N	Part	Quantity
①	A201	4" Pull Rod	1	①	A201	4" Pull Rod	1	①	A201	4" Pull Rod	1
②	A301	Fixing Knob	7	②	A301	Fixing Knob	5	②	A301	Fixing Knob	5
③	A321	Bolt	7	③	A321	Bolt	5	③	A321	Bolt	5
④	A228	4" Fixed Exit	1	④	A228	4" Fixed Exit	1	④	A228	4" Fixed Exit	1
⑤	A229	4" Fixed Exit Cover	1	⑤	A229	4" Fixed Exit Cover	1	⑤	A229	4" Fixed Exit Cover	1
⑥	A230	4" Runner	1	⑥	A230	4" Runner	1	⑥	A230	4" Runner	1
⑦	A303	Hinge	2	⑦				⑦			
⑧	A210	Trumpet Flare	2	⑧	A210	Trumpet Flare	2	⑧	A210	Trumpet Flare	2
⑨	A324	Lock Washer	3	⑨	A324	Lock Washer	3	⑨	A324	Lock Washer	3
⑩	A319	6" Straight Unit	N/A	⑩	A501	10" Straight Unit	N/A	⑩	A403	12" Straight Unit	N/A
⑪	A302	6" Straight Unit Cover	N/A	⑪	A510	10" Straight Unit Cover	N/A	⑪	A422	12" Straight Unit Cover	N/A

Downspout with Flex Tube

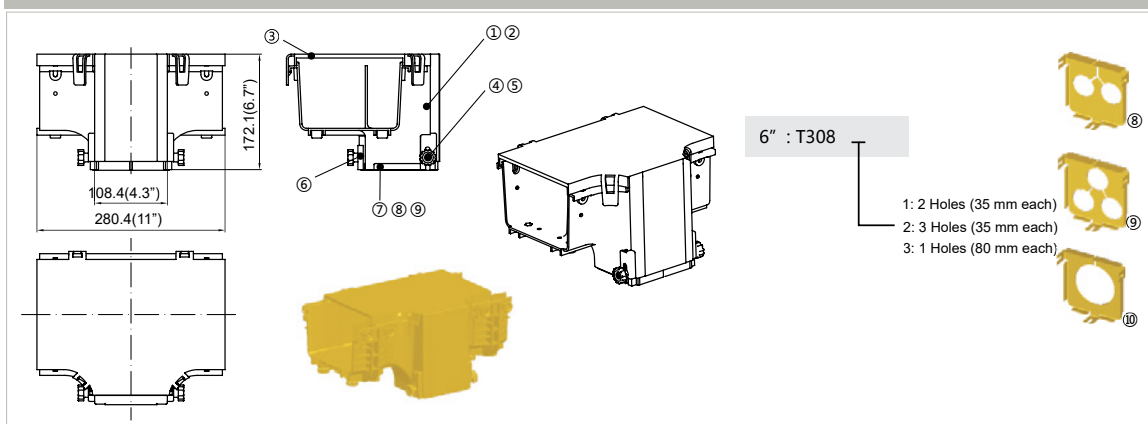

Downspout for 6" Duct P/N: T308_

	Item	P/N	Part	Quantity
P/N: T308_	①	A308	6" Downspout	1
	②	A355	6" Downspout Front Cover	1
	③	A313 (D)	6" to 4" Horizontal T Cover	1
	④	A301	Fixing Knob	3
	⑤	A321	Bolt	3
	⑥	A324	Lock Washer	3
	⑦	A432	4" Fiber Board (1)	Choose one
	⑧	A433	4" Fiber Board (2)	
	⑨	A443	4" Fiber Board (3)	

Downspout with Trumpet Flare

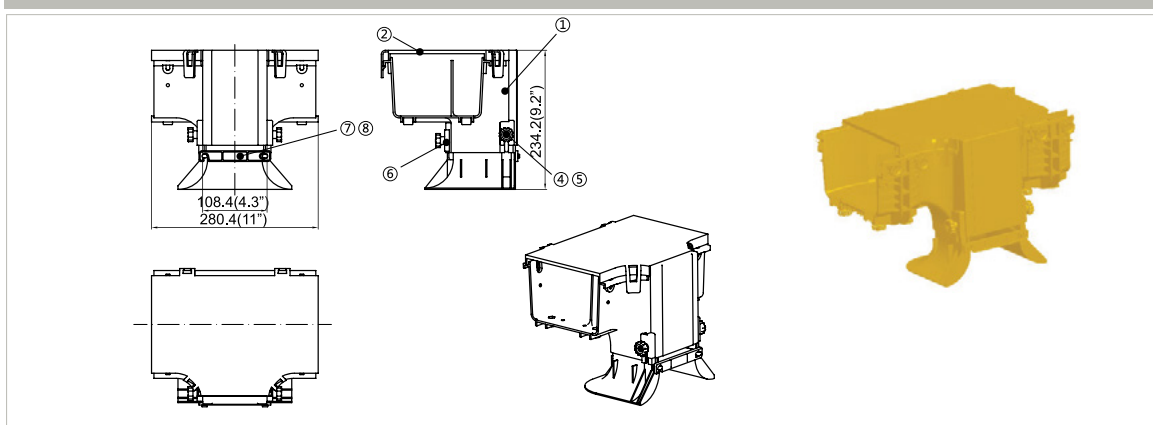

Downspout for 6" Duct P/N: T3084

	Item	P/N	Part	Quantity
P/N: T3084	①	A308	6" Downspout	1
	②	A355	6" Downspout Front Cover	1
	④	A301	Fixing Knob	3
	⑤	A321	Bolt	3
	⑥	A324	Lock Washer	3
	⑦	A201	4" Pull Rod	1
	⑧	A210	4" Trumpet Flare	1

Downspout with Flex Tube

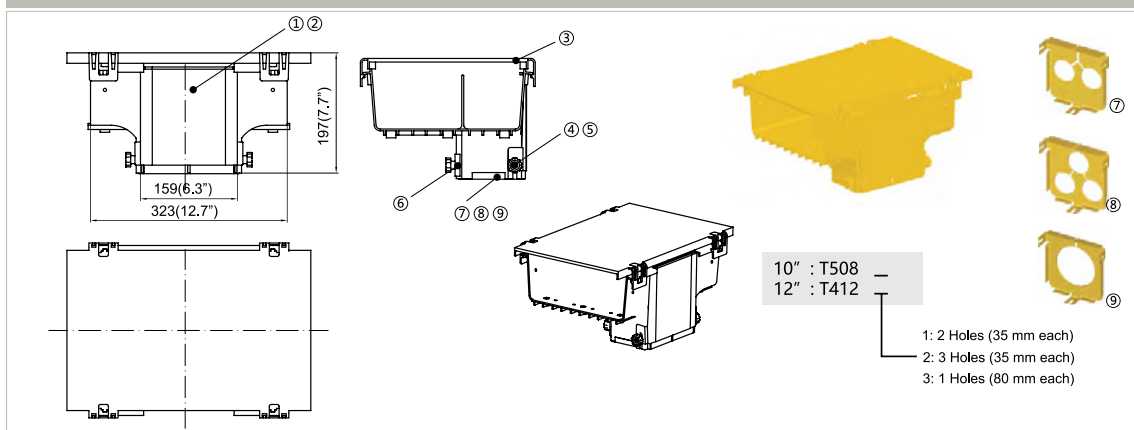

Downspout for 10" Duct P/N: T508_				Downspout for 12" Duct P/N: T412_			
Item	P/N	Part	Quantity	Item	P/N	Part	Quantity
①	A508	10" Downspout	1	①	A412	12" Downspout	1
②	A444	12" Downspout Front Cover	1	②	A444	12" Downspout Front Cover	1
③	A510	10" Straight Unit Cover	1	③	A422	12" Straight Unit Cover	1
④	A301	Fixing Knob	4	④	A301	Fixing Knob	4
⑤	A321	Bolt	4	⑤	A321	Bolt	4
⑥	A324	Lock Washer	4	⑥	A324	Lock Washer	4
⑦	A450	12" Fiber Board (1)	Choose one	⑦	A450	12" Fiber Board (1)	Choose one
⑧	A451	12" Fiber Board (2)		⑧	A451	12" Fiber Board (2)	
⑨	A452	12" Fiber Board (3)		⑨	A452	12" Fiber Board (3)	

Downspout with Trumpet Flare

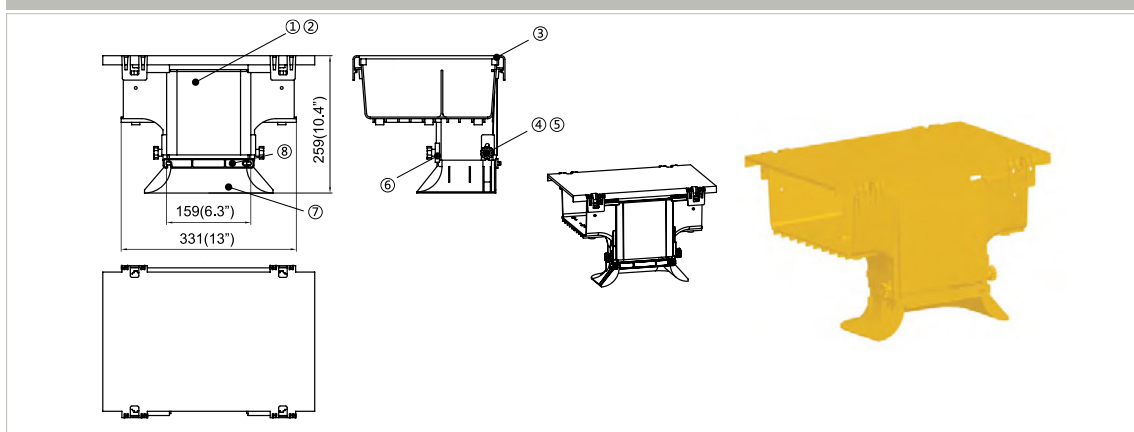

Downspout for 10" Duct P/N: T5084				Downspout for 12" Duct P/N: T4124			
Item	P/N	Part	Quantity	Item	P/N	Part	Quantity
①	A508	10" Downspout	1	①	A412	12" Downspout	1
②	A444	12" Downspout Front Cover	1	②	A444	12" Downspout Front Cover	1
③	A510	10" Straight Unit Cover	1	③	A422	12" Straight Unit Cover	1
④	A301	Fixing Knob	4	④	A301	Fixing Knob	4
⑤	A321	Bolt	4	⑤	A321	Bolt	4
⑥	A324	Lock Washer	4	⑥	A324	Lock Washer	4
⑦	A310	6" Trumpet flare	1	⑦	A310	6" Trumpet flare	1
⑧	A304	6" Pull rod	1	⑧	A304	6" Pull rod	1

*T5084 in previous version

OPTICAL CABLE DUCT INSTALLATION/SUPPORTING SYSTEMS



Installation / Supporting Systems

- Anchor Support
- Trapeze Support
- Top of Rack/Cabinet Support
- Auxiliary Framing Support
- Side Bracing Support

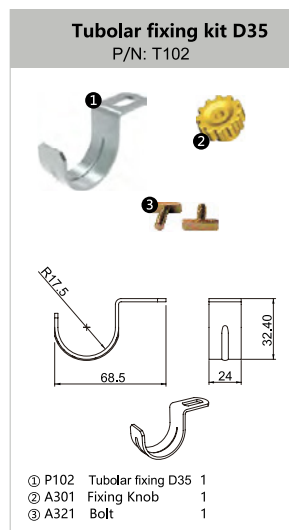
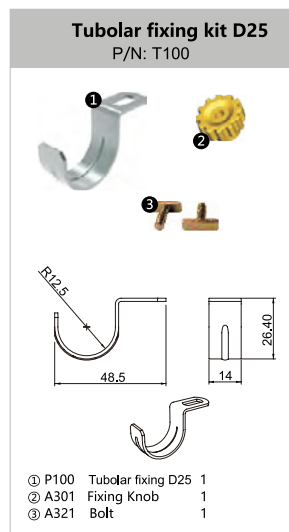

Anchor Support

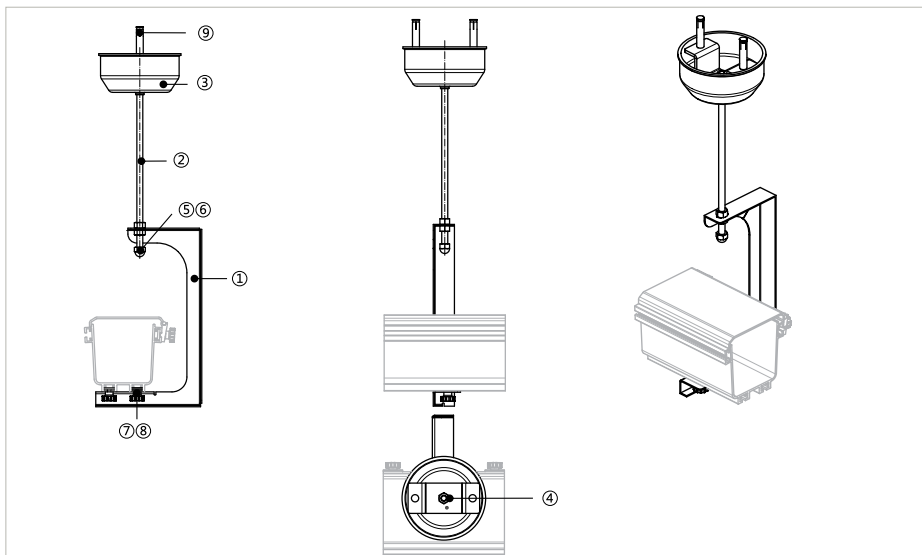

Installation Parts

	Item	P/N	Part	Quantity
4" P/N: T2170	①	T217	4" C-Bracket	1
	②	PS10*	Threaded Rod	1
	③	TJ021	Ejector Sleeve	1
	④	A222	Supporting Bracket	1
	⑤	GB/T6170-2000	M10 Screw Nut Kits	4
	⑥	GB923-88	M10 Cap Nut	1
	⑦	A301	Fixing Knob	2
	⑧	A321	Bolt	2
	⑨		M8 Expansion Screw	2
6" P/N: T3300	①	T330	6" C-Bracket	1
	②	PS10*	Threaded Rod	1
	③	TJ021	Ejector Sleeve	1
	④	A222	Supporting Bracket	1
	⑤	GB/T6170-2000	M10 Screw Nut Kits	4
	⑥	GB923-88	M10 Cap Nut	1
	⑦	A301	Fixing Knob	2
	⑧	A321	Bolt	2
	⑨		M8 Expansion Screw	2
10" P/N: T5540 (T540 in previous version)	①	T554	10" C-Bracket	1
	②	PS10*	Threaded Rod	1
	③	TJ021	Ejector Sleeve	1
	④	A222	Supporting Bracket	1
	⑤	GB/T6170-2000	M10 Screw Nut Kits	4
	⑥	GB923-88	M10 Cap Nut	1
	⑦	A301	Fixing Knob	3
	⑧	A321	Bolt	3
	⑨		M8 Expansion Screw	3
12" P/N: T4350	①	T435	12" C-Bracket	1
	②	PS10*	Threaded Rod	1
	③	TJ021	Ejector Sleeve	1
	④	A222	Supporting Bracket	1
	⑤	GB/T6170-2000	M10 Screw Nut Kits	4
	⑥	GB923-88	M10 Cap Nut	1
	⑦	A301	Fixing Knob	3
	⑧	A321	Bolt	3
	⑨		M8 Expansion Screw	3

* Recommended Threaded Rod Diameter is 10mm and length is upon request.
Please state the required length on the PO.



Trapeze Support

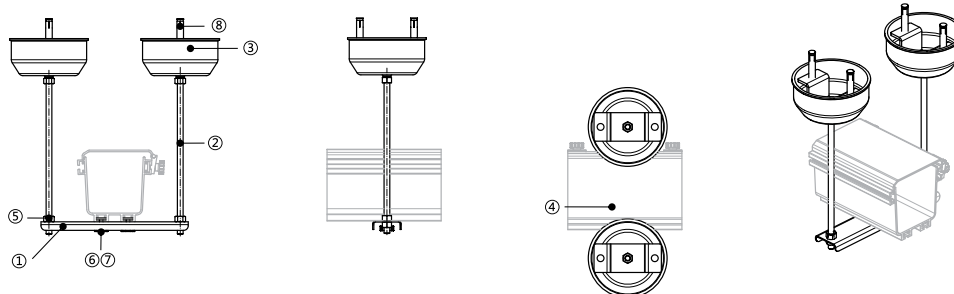

Installation Parts

	Item	P/N	Part	Quantity		Item	P/N	Part	Quantity
4" P/N: T225	①	A225	4" Trapeze bracket	1	6" P/N: T338	①	A338	6" Trapeze bracket	1
	②	PS10*	Threaded Rod	2		②	PS10*	Threaded Rod	2
	③	TJ021	Ejector Sleeve	2		③	TJ021	Ejector Sleeve	2
	④	A222	Supporting Bracket	2		④	A222	Supporting Bracket	2
	⑤	GB/T6170-2000	M10 Screw Nut Kits	8		⑤	GB/T6170-2000	M10 Screw Nut Kits	8
	⑥	A301	Fixing Knob	2		⑥	A301	Fixing Knob	2
	⑦	A321	Bolt	2		⑦	A321	Bolt	2
	⑧		M8 Expansion Screw	4		⑧		M8 Expansion Screw	4
10" P/N: T551	①	A551	10" Trapeze bracket	1	12" P/N: T440	①	A440	12" Trapeze bracket	1
	②	PS10*	Threaded Rod	2		②	PS10*	Threaded Rod	2
	③	TJ021	Ejector Sleeve	2		③	TJ021	Ejector Sleeve	2
	④	A222	Supporting Bracket	2		④	A222	Supporting Bracket	2
	⑤	GB/T6170-2000	M10 Screw Nut Kits	8		⑤	GB/T6170-2000	M10 Screw Nut Kits	8
	⑥	A301	Fixing Knob	3		⑥	A301	Fixing Knob	3
	⑦	A321	Bolt	3		⑦	A321	Bolt	3
	⑧		M8 Expansion Screw	4		⑧		M8 Expansion Screw	4

Top of Rack/Cabinet Support

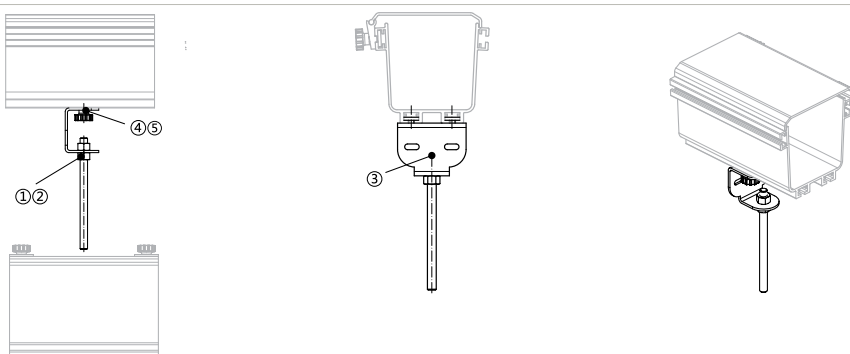

Installation Parts

	Item	P/N	Part	Quantity		Item	P/N	Part	Quantity
4" P/N: T226	①	PS12*	Threaded Rod	1	6" P/N: T339	①	PS12*	Threaded Rod	1
	②	GB/T6170-2000	M12 Screw Nut Kits	2		②	GB/T6170-2000	M12 Screw Nut Kits	2
	③	A226	4" Center Support Bracket	1		③	A339	6" Center Support Bracket	1
	④	A301	Fixing Knob	2		④	A301	Fixing Knob	2
	⑤	A321	Bolt	2		⑤	A321	Bolt	2
10" P/N: T552	①	PS12*	Threaded Rod	1	12" P/N: T441	①	PS12*	Threaded Rod	1
	②	GB/T6170-2000	M12 Screw Nut Kits	2		②	GB/T6170-2000	M12 Screw Nut Kits	2
	③	A552	10" Center Support Bracket	1		③	A441	12" Center Support Bracket	1
	④	A301	Fixing Knob	3		④	A301	Fixing Knob	3
	⑤	A321	Bolt	3		⑤	A321	Bolt	3

* Recommended Threaded Rod Diameter is 10mm and length is upon request.
Please state the required length on the PO.

OPTICAL CABLE DUCT INSTALLATION/SUPPORTING SYSTEMS



Auxiliary Framing support

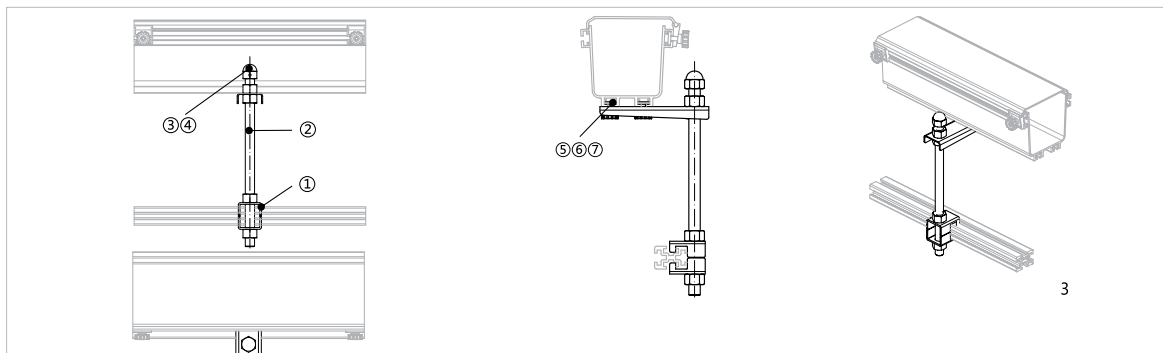

Installation Parts

	Item	P/N	Part	Quantity		Item	P/N	Part	Quantity
4" P/N: T227	①	A342	Ladder Rack Bracket	2	6" P/N: T345	①	A342	Ladder Rack Bracket	2
	②	PS16*	Threaded rod	1		②	PS16*	Threaded rod	1
	③	GB/T6170-2000	M16 Screw Nut Kits	4		③	GB/T6170-2000	M16 Screw Nut Kits	4
	④	GB923-88	M16 Cap Nut	1		④	GB923-88	M16 Cap Nut	1
	⑤	A227	4" Supporting Bracket(2)	1		⑤	A345	6" Supporting Bracket(2)	1
	⑥	A301	Fixing Knob	2		⑥	A301	Fixing Knob	2
	⑦	A321	Bolt	2		⑦	A321	Bolt	2
10" P/N: T550	①	A342	Ladder Rack Bracket	2	12" P/N: T446	①	A342	Ladder Rack Bracket	2
	②	PS16*	Threaded rod	1		②	PS16*	Threaded rod	1
	③	GB/T6170-2000	M16 Screw Nut Kits	4		③	GB/T6170-2000	M16 Screw Nut Kits	4
	④	GB923-88	M16 Cap Nut	1		④	GB923-88	M16 Cap Nut	1
	⑤	A550	10" Supporting Bracket(2)	1		⑤	A446	12" Supporting Bracket(2)	1
	⑥	A301	Fixing Knob	3		⑥	A301	Fixing Knob	2
	⑦	A321	Bolt	3		⑦	A321	Bolt	2

Wall Support

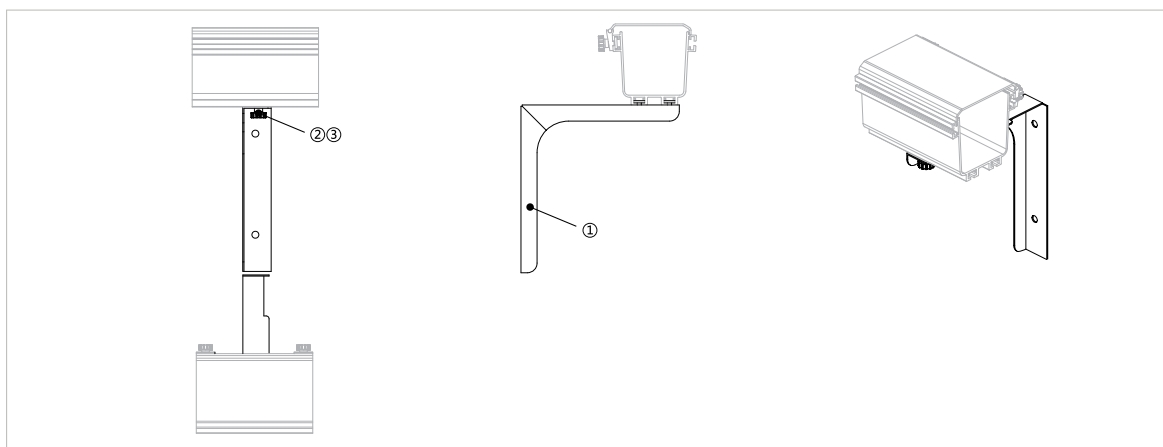

Installation Parts

	Item	P/N	Part	Quantity		Item	P/N	Part	Quantity
4" P/N: T2240	①	T224	4" Side support bracket	1	6" P/N: T3370	①	T337	6" Side support bracket	1
	②	A301	Fixing Knob	2		②	A301	Fixing Knob	2
	③	A321	Bolt	2		③	A321	Bolt	2
10" P/N: T5530	①	T553	10" Side Support Bracket	1	12" P/N: T4420	①	T442	12" Side Support Bracket	1
	②	A301	Fixing Knob	3		②	A301	Fixing Knob	3
	③	A321	Bolt	3		③	A321	Bolt	3

* Recommended Threaded Rod Diameter is 10mm and length is upon request.
Please state the required length on the PO.



Part Number	Description	Page Number	Part Number	Description	Page Number
2"x 2" parts			4"x 10" parts		
A101	2" Straight Unit	6	A501	10" Straight Unit	14
A102	2" Straight Unit Cover	6	A503	10" Horizontal Cross	15
A104	2" 90° Horizontal Curve	6	A504	10" Horizontal T	14
A105	2" 90° Horizontal Curve Cover	6	A506	10" Horizontal Cross Cover	15
A106	2" Horizontal T	6	A507	10" Horizontal T Cover	14
A107	2" Horizontal T Cover	6	A510	10" Straight Unit Cover	14
A108	2" Coupler	6	A512	10" 90° Horizontal Curve Cover	14
A114	2" End Cap	6	A513	10" 90° Horizontal Curve	14
A115	2" 90° Up Curve	7	A522	10" End Cap	15
A116	2" 90° Up Curve Cover	7	A529	10" Special Part End Cap	15
A117	2" 90° Down Curve	7	T5021	10" Coupler Kit A	14
A118	2" 90° Down Curve Cover	7	T5022	10" Coupler Kit B	14
			T5022S	10" Coupler Kit S	14
4"x 4" parts			4"x 12" parts		
A203	4" Straight Unit	8	A403	12" Straight Unit	16
A205	4" Horizontal T	9	A404	12" 90° Down Curve	18
A206	4" Horizontal T Cover	9	A405	12" 45° Down Curve	17
A207	4" 45° Up Curve	9	A406	12" 45° Up Curve	17
A208	4" 45° Down Curve	9	A407	12" Horizontal Cross	17
A209	4" 90° Down Curve	9	A417	12" Horizontal T	17
A211	4" 90° Horizontal Curve	8	A418	12" Horizontal T Cover	17
A212	4" 90° Horizontal Curve Cover	8	A420	12" Horizontal Cross Cover	17
A214	4" End Cap	8	A422	12" Straight Unit Cover	16
A216	4" Special Part End Cap	8	A425	12" 90° Horizontal Curve Cover	16
A232	4" Storage Duct Cover	9	A426	12" 45° Horizontal Curve Cover	17
A235	4" Horizontal Cross	8	A427	12" 45° Horizontal Curve	17
A236	4" Horizontal Cross Cover	8	A429	12" 90° Horizontal Curve	16
T202	4" Straight Unit Cover Kit	8	A431	12" End Cap	16
T2041	4" Coupler Kit A	8	A434	12" Special Part End Cap	16
T2042	4" Coupler Kit B	8	T4281	12" Coupler Kit A A	16
T2042S	4" Coupler Kit S	8	T4282	12" Coupler Kit B	16
T2043	4" Coupler Spill Over Kit	8	T4282S	12" Coupler Kit S	16
T203	4" Vertical Cover Kit	8	T437	12" 45° Up Curve Cover Kit	17
T219	4" 45° Up Curve Cover Kit	9	T438	12" 45° Down Curve Cover Kit	17
T220	4" 45° Down Curve Cover Kit	9	T439	12" 90° Down Curve Cover Kit	18
T221	4" 90° Down Curve Cover Kit	9			
T231	4" Storage Duct	9	AD-OLPAN 12x4	Fitting for Transitions Kit	18
A241	Vertical T	10	AD-OLADC 12x4	Fitting for Transitions Kit	18
A242	Vertical T Cover	10			
4"x 6" parts					
A305	6" 90° Down Curve	12			
A306	6" 45° Down Curve	12			
A307	6" 45° Up Curve	12			
A314	6" Horizontal T Cover	12			
A315	6" 90° Horizontal Curve	11			
A317	6" Horizontal T	12			
A318	6" 90° Horizontal Curve Cover	11			
A319	6" Straight Unit	11			
A322	6" End Cap	11			
A325	6" Special Part End Cap	11			
A327	6" Horizontal Cross	12			
A328	6" Horizontal Cross Cover	12			
A349	6" Storage Duct Cover	13			
T302	6" Straight Unit Cover Kit	11			
T303	6" Vertical Cover Kit	11			
T3161	6" Coupler Kit A	11			
T3162	6" Coupler Kit B	11			
T3162S	6" Coupler Kit S	11			
T334	6" 45° Up Curve Cover Kit	12			
T335	6" 45° Down Curve Cover Kit	12			
T336	6" 90° Down Curve Cover Kit	12			
T347	6" Storage Duct	13			
AD-OLPAN 6x4	Fitting for Transitions Kit	12			
AD-OLADC 6x4	Fitting for Transitions Kit	13			



Part Number	Description	Page Number	Part Number	Description	Page Number
Hybrid			Exit		
A313	6" to 4" Horizontal T Cover	22	T2341	2" Quick Exit Kit with Flex Tube Drop 2 for 4" Tray 2	25
A320	6" to 4" Horizontal T	22	T2342	2" Quick Exit Kit with Flex Tube Drop 2 for 6" Tray 2	25
A326	6" to 4" Horizontal Cross	22	T2343	2" Quick Exit Kit with Trumpet Flare Drop 2 for 4" Tray 2	25
A329	6" to 4" Horizontal Cross Cover	22	T2344	2" Quick Exit Kit with Trumpet Flare Drop 2 for 6" Tray 2	25
A350	6" to 4" Adapter	22	T41341	4" Quick Exit Kit with Flex Tube Drop 1 for 4" Tray with 2 holes	27
A351	6" to 4" Adapter Cover	22	T41342	4" Quick Exit Kit with Flex Tube Drop 1 for 4" Tray with 3 holes	27
A408	12" to 6" Horizontal T	23	T41343	4" Quick Exit Kit with Flex Tube Drop 1 for 4" Tray with 1 hole	27
A409	12" to 6" Adapter	18	T41344	4" Quick Exit Kit with Trumpet Flare Drop 1 for 4" Tray	28
A410	12" to 6" Horizontal Cross	23	T41311	4" Quick Exit Kit with Flex Tube Drop 1 for 6" Tray with 2 holes	27
A411	12" to Dual 6" Adapter	23	T41312	4" Quick Exit Kit with Flex Tube Drop 1 for 6" Tray with 3 holes	27
A419	12" to 6" Horizontal T Cover	23	T41313	4" Quick Exit Kit with Flex Tube Drop 1 for 6" Tray with 1 hole	27
A421	12" to 6" Horizontal Cross Cover	23	T41314	4" Quick Exit Kit with Trumpet Flare Drop 1 for 6" Tray	28
A423	12" to 6" Adapter	23	T41321	4" Quick Exit Kit with Flex Tube Drop 1 for 10" Tray with 2 holes	27
A424	12" to 6" Adapter Cover	23	T41322	4" Quick Exit Kit with Flex Tube Drop 1 for 10" Tray with 3 holes	27
A505	10" to 6" Adapter	22	T41323	4" Quick Exit Kit with Flex Tube Drop 1 for 10" Tray with 1 hole	27
A509	10" to 6" Adapter Cover	22	T41324	4" Quick Exit Kit with Trumpet Flare Drop 1 for 10" Tray	28
T445	12" to 10" Connector Kit	23	T41331	4" Quick Exit Kit with Flex Tube Drop 1 for 12" Tray with 2 holes	27
Flex Tube			T41332	4" Quick Exit Kit with Flex Tube Drop 2 for 12" Tray with 3 holes	27
C35	Flex Tube (diameter: 35mm)	24	T41333	4" Quick Exit Kit with Flex Tube Drop 1 for 12" Tray with 1 hole	27
C80	Flex Tube (diameter: 80mm)	24	T41334	4" Quick Exit Kit with Trumpet Flare Drop 1 for 12" Tray	28
A35	Flex tube retention clip (For C35)	24	T1111	2" Fixed Exit Kit with Flex Tube Drop 2 for 4" Tray	29
Installation			T1112	2" Fixed Exit Kit with Flex Tube Drop 2 for 6" Tray	29
T202	4" Straight Unit Cover Kit	20	T1113	2" Fixed Exit Kit with Trumpet Flare Drop 2 for 4" Tray	29
T302	6" Straight Unit Cover Kit	20	T1114	2" Fixed Exit Kit with Trumpet Flare Drop 2 for 6" Tray	29
T2041	4" Coupler Kit A For Straight Section	20	T35241	4" Quick Exit Kit with Flex Tube Drop 2 for 4" Tray with 2 holes	29
T3161	6" Coupler Kit A For Straight Section	20	T35242	4" Quick Exit Kit with Flex Tube Drop 2 for 4" Tray with 3 holes	29
T5021	10" Coupler Kit A For Straight Section	20	T35243	4" Quick Exit Kit with Flex Tube Drop 2 for 4" Tray with 1 hole	29
T4281	12" Coupler Kit A For Straight Section	20	T35244	4" Quick Exit Kit with Trumpet Flare Drop 2 for 4" Tray	30
T2042	4" Coupler Kit B For Straight Section	20	T35211	4" Quick Exit Kit with Flex Tube Drop 2 for 6" Tray with 2 holes	29
T3162	6" Coupler Kit B For Straight Section	20	T35212	4" Quick Exit Kit with Flex Tube Drop 2 for 6" Tray with 3 holes	29
T5022	10" Coupler Kit B For Straight Section	20	T35213	4" Quick Exit Kit with Flex Tube Drop 2 for 6" Tray with 1 hole	29
T4282	12" Coupler Kit B For Straight Section	20	T35214	4" Quick Exit Kit with Trumpet Flare Drop 2 for 6" Tray	30
T100	Tubular fixing kit	34	T35221	4" Quick Exit Kit with Flex Tube Drop 2 for 10" Tray with 2 holes	29
T2170	4" Anchor Support Kit	34	T35222	4" Quick Exit Kit with Flex Tube Drop 2 for 10" Tray with 3 holes	29
T3300	6" Anchor Support Kit	34	T35223	4" Quick Exit Kit with Flex Tube Drop 2 for 10" Tray with 1 hole	29
T540	10" Anchor Support Kit	34	T35224	4" Quick Exit Kit with Trumpet Flare Drop 2 for 10" Tray	30
T4350	12" Anchor Support Kit	34	T35231	4" Quick Exit Kit with Flex Tube Drop 2 for 12" Tray with 2 holes	29
T225	4" Trapeze Support Kit	35	T35232	4" Quick Exit Kit with Flex Tube Drop 2 for 12" Tray with 3 holes	29
T338	6" Trapeze Support Kit	35	T35233	4" Quick Exit Kit with Flex Tube Drop 2 for 12" Tray with 1 hole	29
T551	10" Trapeze Support Kit	35	T35234	4" Quick Exit Kit with Trumpet Flare Drop 2 for 12" Tray	30
T440	12" Trapeze Support Kit	35	T22811	4" Fixed Exit Kit with Flex Tube Drop for 6" Tray with 2 holes	31
T226	4" Top of Rack/Cabinet Support Kit	35	T22812	4" Fixed Exit Kit with Flex Tube Drop for 6" Tray with 3 holes	31
T339	6" Top of Rack/Cabinet Support Kit	35	T22813	4" Fixed Exit Kit with Flex Tube Drop for 6" Tray with 1 hole	31
T552	10" Top of Rack/Cabinet Support Kit	35	T22814	4" Fixed Exit Kit with Trumpet Flare Drop for 6" Tray	31
T441	12" Top of Rack/Cabinet Support Kit	35	T22821	4" Fixed Exit Kit with Flex Tube Drop for 10" Tray with 2 holes	31
T227	4" Auxiliary Framing Support Kit	36	T22822	4" Fixed Exit Kit with Flex Tube Drop for 10" Tray with 3 holes	31
T345	6" Auxiliary Framing Support Kit	36	T22823	4" Fixed Exit Kit with Flex Tube Drop for 10" Tray with 1 hole	31
T550	10" Auxiliary Framing Support Kit	36	T22824	4" Fixed Exit Kit with Trumpet Flare Drop for 10" Tray	31
T446	12" Auxiliary Framing Support Kit	36	T22831	4" Fixed Exit Kit with Flex Tube Drop for 12" Tray with 2 holes	31
T2240	4" Wall Support Kit	36	T22832	4" Fixed Exit Kit with Flex Tube Drop for 12" Tray with 3 holes	31
T3370	6" Wall Support Kit	36	T22833	4" Fixed Exit Kit with Flex Tube Drop for 12" Tray with 1 hole	31
T5530	10" Wall Support Kit	36	T22834	4" Fixed Exit Kit with Trumpet Flare Drop for 12" Tray	31
T4420	12" Wall Support Kit	36	T3081	Downspout with Flex Tube Drop with 2 holes for 6" Tray	31
Example			T3082	Downspout with Flex Tube Drop with 3 holes for 6" Tray	31
	45° Climbing Installation (4")	21	T3083	Downspout with Flex Tube Drop with 1 hole for 6" Tray	31
	90° Climbing Installation (4")	21	T3084	Downspout with Trumpet Flare Drop for 6" Tray	32
Exit			T5081	Downspout with Flex Tube Drop with 2 holes for 10" Tray	33
T3091	2" Quick Exit Kit with Flex Tube Drop for 4" Tray 1	24	T5082	Downspout with Flex Tube Drop with 3 holes for 10" Tray	33
T3092	2" Quick Exit Kit with Flex Tube Drop for 6" Tray 1	24	T5083	Downspout with Flex Tube Drop with 1 hole for 10" Tray	33
T3093	2" Quick Exit Kit with Trumpet Flare Drop for 4" Tray 1	24	T5084	Downspout with Trumpet Flare Drop for 10" Tray	33
T3094	2" Quick Exit Kit with Trumpet Flare Drop for 6" Tray 1	24	T4121	Downspout with Flex Tube Drop with 2 holes for 12" Tray	33
			T4122	Downspout with Flex Tube Drop with 3 holes for 12" Tray	31
			T4123	Downspout with Flex Tube Drop with 1 hole for 12" Tray	33
			T4124	Downspout with Trumpet Flare Drop for 12" Tray	33

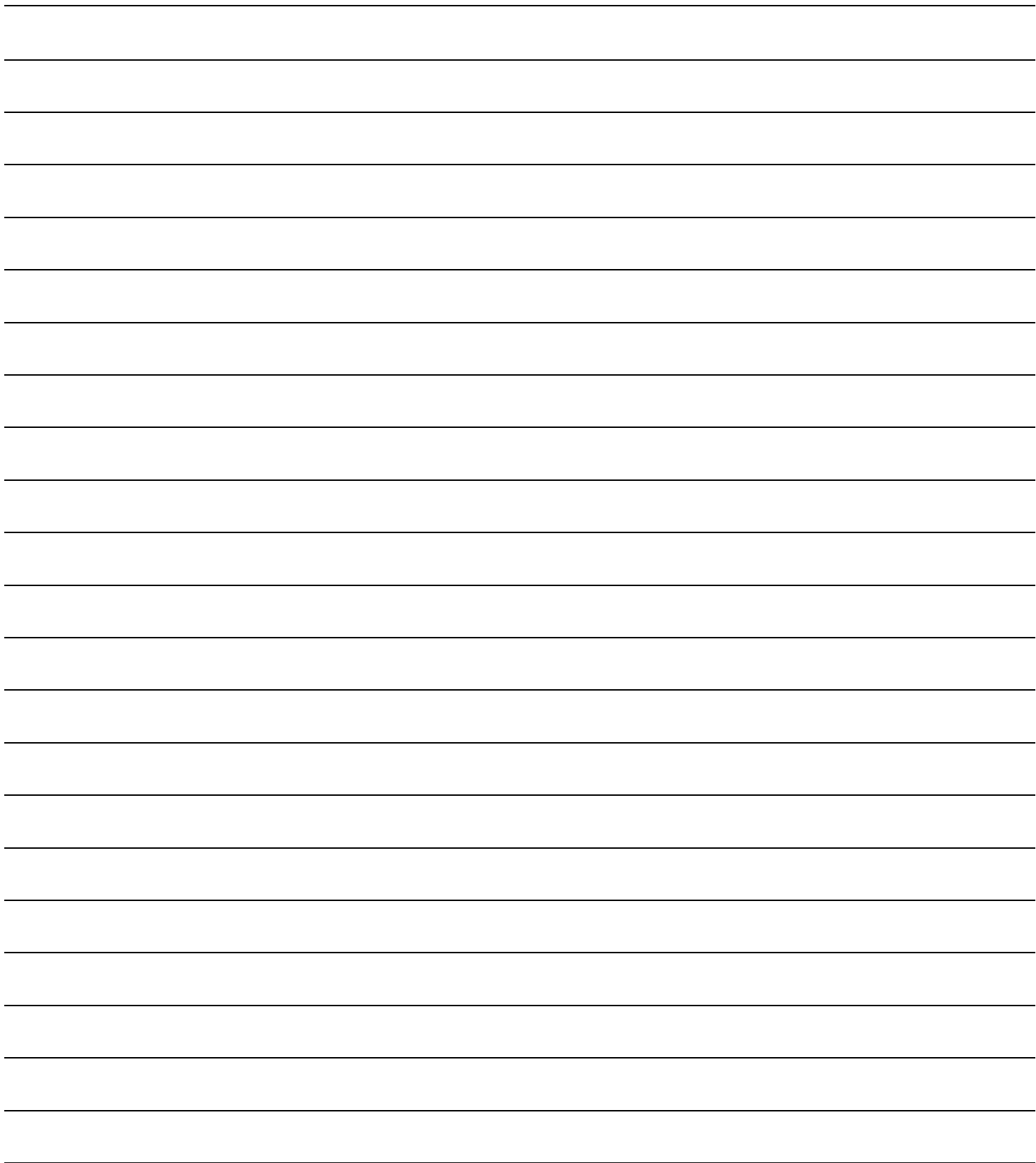

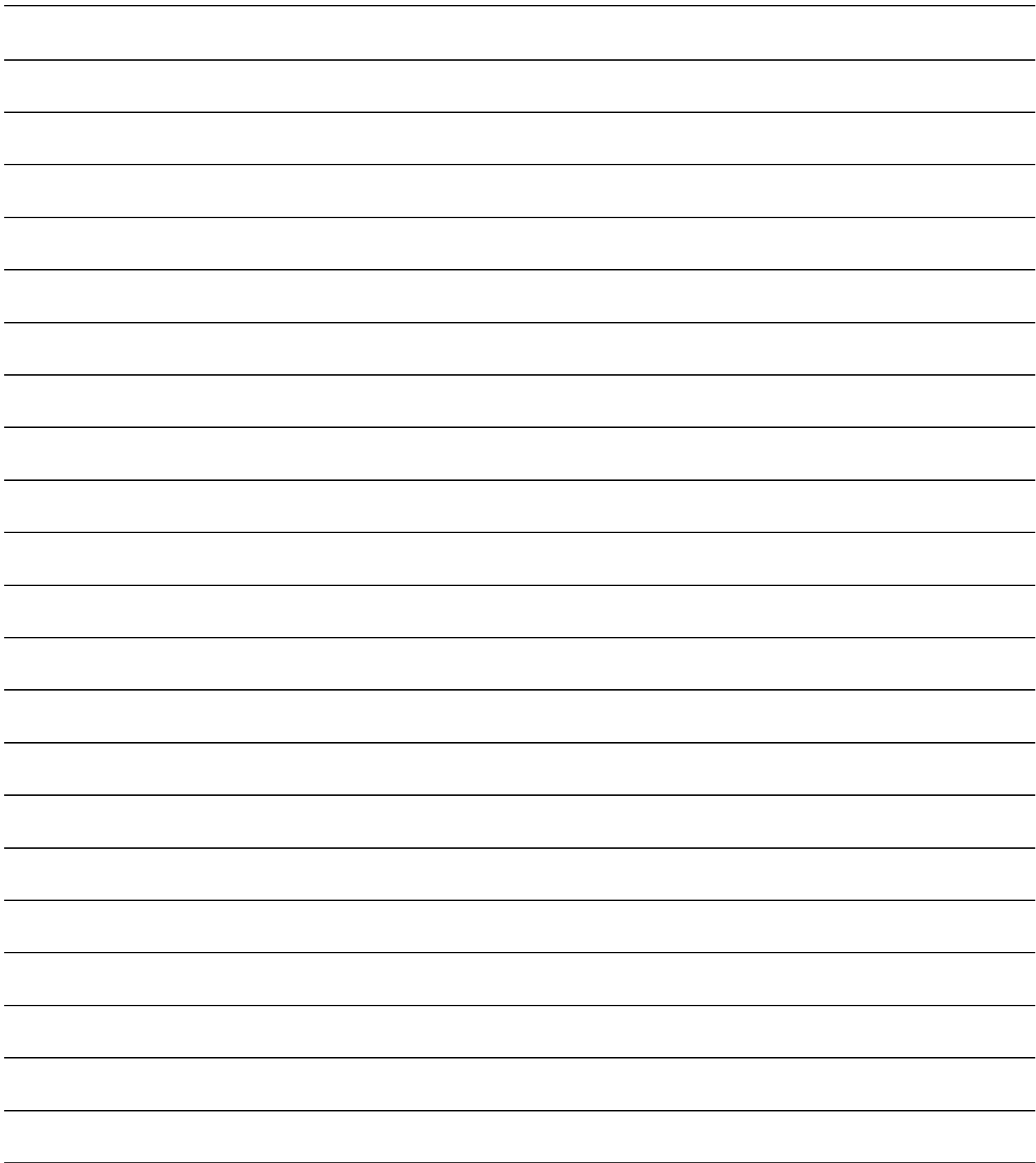

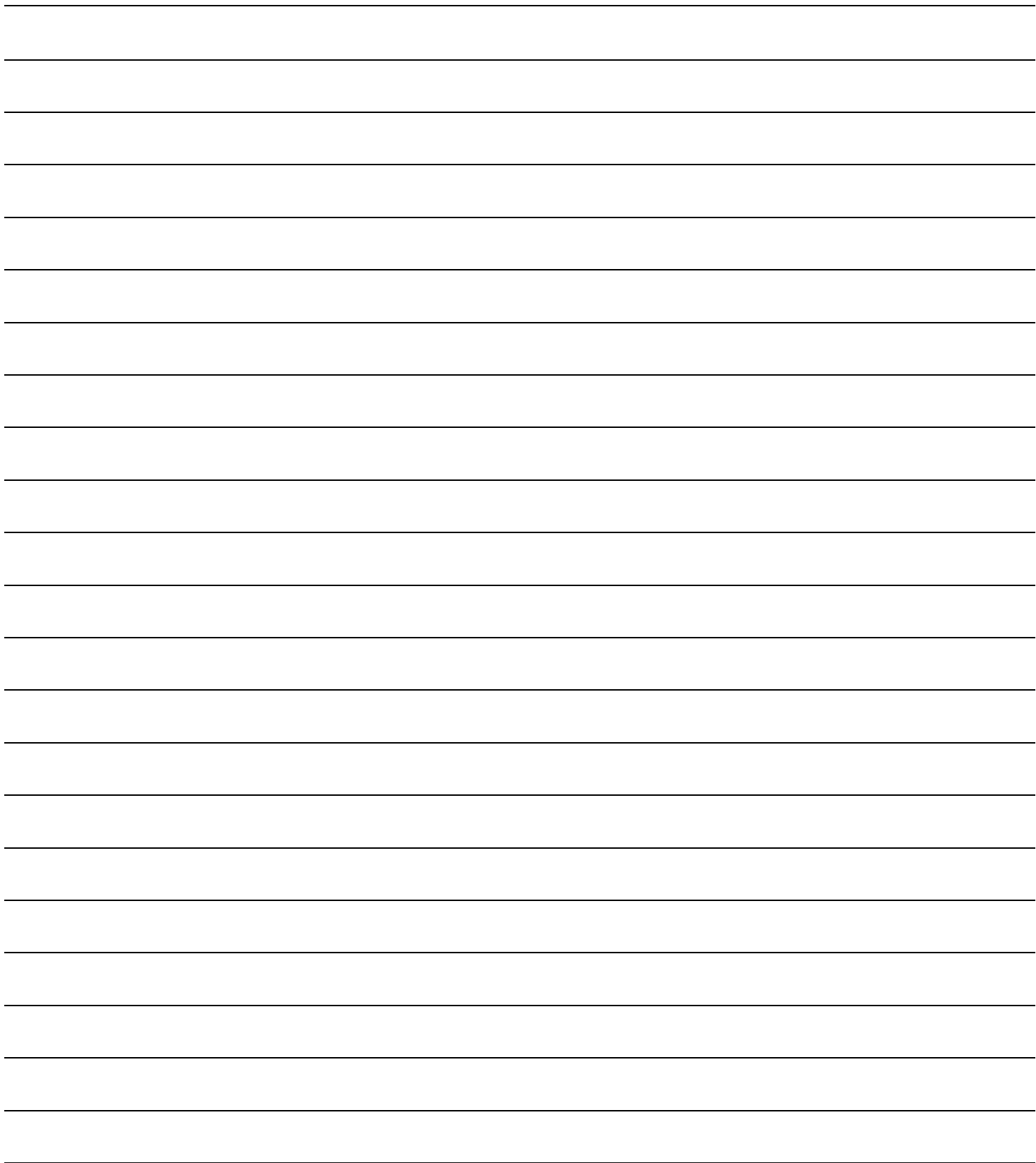







Tel. +39 0690405273

info@outline.company - www.outline.company

Via degli Olmetti, 39D - 00060 Formello (RM)